

User's manual
(Translation of original
instructions)

EN



N420938A - Rev.00 - 06/23

InnovApp

conditioners
fan coil

First of all, we would like to thank you for having chosen a device of our production.

We are sure you will be happy with it because it represents the state of the art in the technology of home air conditioning.

By following the suggestions contained in this manual, the product you have purchased will operate without problems giving you optimum room temperatures with minimum energy costs.

INNOVA S.r.l.

Conformity

Refer to the Installer Manual of the paired unit.

Markings



TABLE OF CONTENTS

1	General information	p. 6
1.1	About the manual.	p. 6
1.1.1	Editorial pictograms	p. 6
1.1.2	Pictograms on the product.	p. 6
1.1.3	Recipients	p. 6
1.1.4	Manual organisation	p. 7
1.2	Disposal.	p. 7
1.3	General warnings	p. 7
2	Installation	p. 8
2.1	Description.	p. 8
2.1.1	Main functions	p. 8
2.2	Configurable products	p. 8
2.3	Downloading the application	p. 8
2.3.1	Minimum requirements	p. 8
2.3.2	Android users	p. 8
2.3.3	iOS users	p. 8
2.3.4	Web users.	p. 8
3	Preliminary settings	p. 9
3.1	Preliminary warnings.	p. 9
3.2	Access to the App	p. 9
3.2.1	Registration through Facebook account	p. 9
3.2.2	Registration through Apple account.	p. 9
3.2.3	Registration through Google account	p. 9
3.2.4	Registration by email	p. 9
3.2.5	Privacy consents	p. 10
3.3	Configuration	p. 10
3.3.1	Fan coil configuration	p. 11
3.3.2	Conditioner configuration	p. 12
4	Basic settings	p. 13
4.1	Main screen	p. 13
4.1.1	Interface	p. 13
4.2	Out of home function.	p. 13
4.2.1	Activation	p. 14
4.2.2	Deactivation	p. 14
4.2.3	Changing settings	p. 14
4.3	Warm up/Cooling down mode	p. 14
4.4	Switch off/Reset schedules function	p. 14
4.4.1	Activating Manual operation	p. 14
4.4.2	Reset schedules	p. 14
4.5	Planning	p. 15

4.5.1	Creating a calendar	p. 15
4.5.2	Associating a calendar with appliances and rooms	p. 16
4.5.3	Programming of time slots and temperature sets	p. 17
4.5.4	Deleting a calendar	p. 19
4.5.5	Calendar specific settings	p. 20
4.6	New device	p. 21
4.6.1	Add manually	p. 21
4.6.2	Automatic search	p. 22

5 General settings [p. 23](#)

5.1	General settings.	p. 23
5.1.1	Interface	p. 23
5.1.2	Description	p. 23
5.2	Manage homes	p. 24
5.2.1	Add a new home	p. 25
5.2.2	Select the home to be displayed	p. 25
5.2.3	Change the name of a home	p. 26
5.2.4	Sharing a home	p. 26
5.2.5	Delete the house	p. 27
5.3	Manage rooms.	p. 28
5.3.1	Add a new room	p. 29
	Associating an appliance with a room	p. 30
5.3.2	Change the name of a room	p. 31
5.3.3	Deleting a room	p. 32
5.4	Planning	p. 32
5.5	New device.	p. 32
5.6	User	p. 33
5.6.1	Language	p. 33
5.6.2	Temperatures	p. 33
5.6.3	Manuals.	p. 33
5.6.4	Privacy	p. 33
5.6.5	Logout	p. 33
5.6.6	Delete user	p. 33
5.7	Time zone and location.	p. 34
5.7.1	Time zone	p. 34
5.7.2	Position	p. 34
5.8	Duration of manual operation	p. 35
5.9	Support	p. 35

6 Device specific commands [p. 36](#)

6.1	Device specific commands.	p. 36
6.1.1	Interface	p. 36
6.2	Device-specific settings	p. 37
6.2.1	Interface	p. 37
6.2.2	Description	p. 38
6.3	Temporary temperature change	p. 38

7 Troubleshooting [p. 39](#)

7.1	Error signals	p. 39
------------	--------------------------------	-----------------------

7.2 Troubleshooting	<u>p. 39</u>
7.3 WiFi network On, Off and Reset.	<u>p. 39</u>
7.3.1 Controls EFA649 - EFB649 - EWF644 - EWF647	<u>p. 39</u>
7.3.2 Controls ECA031 - ECB031 and on-board display unit air conditioners	<u>p. 40</u>

GENERAL INFORMATION

1.1 About the manual

This manual was written to provide all the explanations for the correct management of the appliance.

 This instruction manual forms an integral part of the device and therefore must be carefully preserved and must ALWAYS travel with it, even if you transfer the device to another owner or relocate it to other premises. If the manual gets damaged or lost, download a copy from the website.

 Read this manual carefully before proceeding with any operation and follow the instructions in the individual chapters.

 The manufacturer is not responsible for damages to persons or property caused by failure to follow the instructions in this manual.

 This document is restricted in use to the terms of the law and may not be copied or transferred to third parties without the express authorization of the manufacturer.

1.1.1 Editorial pictograms

The pictograms in the next chapter provide the necessary information for correct, safe use of the machine in a rapid, unmistakable way.

Related to security

High risk warning (bold text)

- The operation described above presents a risk of serious physical injury, fatality, major damage to the appliance and/or to the environment if not carried out in compliance with safety regulations.

Low risk warning (plain text)

- The operation described above presents a risk of minor physical injury or minor damage to the appliance and/or to the environment if not carried out in compliance with safety regulations.

Prohibition (plain text)

- Refers to prohibited actions.

Important information (bold text)

- This indicates important information that must be taken into account during the operations.

In the texts

- procedures
- lists

In the control panels

- actions required
- Expected responses following an action.*

In the figures

1 The numbers indicate the individual components.

A The capital letters indicate component assemblies.

 The white numbers in black marks indicate a series of actions to be carried out in sequence.

 The black letter in white identifies an image when there are several images in the same figure.

1.1.2 Pictograms on the product

Symbols are used in some parts of the appliance:

Related to security



Caution: electrical danger

- The concerned personnel is informed to the presence of electricity and the risk of suffering an electric shock.

1.1.3 Recipients

User

Non-expert person capable of operating the product in safe conditions for people, for the product itself and the environment, interpreting an elementary diagnostic of faults and abnormal operating conditions, carrying out simple adjustment, checking and maintenance operations.

Installer

Expert person qualified to position and connect (hydraulically, electrically, etc.) the unit to the plant; this person is responsible for handling and correct installation according to the instructions provided in this manual and the national standards currently in force.

Technical Service Centre

Expert and qualified person authorised directly by the manufacturer to carry out all routine and supplementary maintenance operations, as well as every adjustment, check, repair and replacement of parts necessary during the life of the unit itself.

1.1.4 Manual organisation

The manual is divided into sections each dedicated to one or more target groups.

General information

It addresses all recipients.

It contains general information and important warnings that should be known before installing and using the appliance.

Installation

It addresses all recipients.

It contains information required for the installation of the mobile application.

App

It addresses all recipients.

It contains useful information for the control of the unit via the app for mobile and the use of main functions.

1.2 Disposal

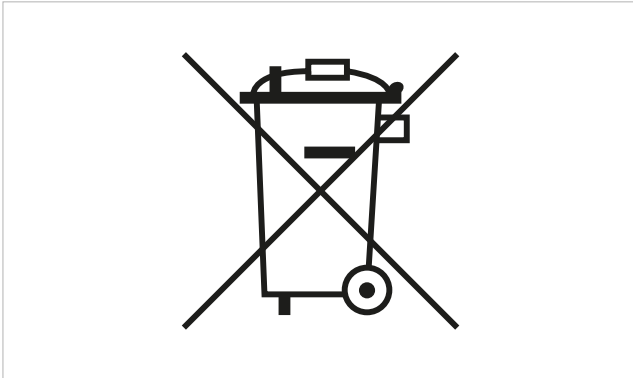

The symbol on the product or its packaging indicates that the product must not be treated as normal household

waste, but must be taken to the appropriate collection point for the recycling of electrical and electronic equipment.

Proper disposal of this product avoids harm to humans and the environment and promotes the reuse of valuable raw materials.

For more detailed information about the recycling of this product, contact your local city office, your household waste disposal service or the shop where you purchased the product.

Illegal disposal of the product by the user involves the application of the administrative sanctions provided for by the regulations in force.

This provision is only valid in the EU Member States.

1.3 General warnings

- ⚠ This instruction is an integral part of the booklet of the appliance.
- ⚠ The manufacturer reserves the right to make changes to its models at any time to improve its product, without prejudice to the essential characteristics described in this manual. The manufacturer is not obliged to add such modifications to machines previously manufactured, already delivered or under construction.
- ⚠ All repair or maintenance interventions must be performed by the technical service department or by professionally qualified personnel as foreseen in this booklet. Do not modify or intervene on the appliance as this could create dangerous situations and the manufacturer will not be responsible for any damage caused.
- ⚠ Objects or structural obstacles (furniture, curtains, plants, leaves, blinds, etc.) must not obstruct the normal air flow both from the internal and from the external grids.
- ⚠ Do not put any containers on top of the appliance, especially if they contain liquids, as this could cause a short circuit or cause damage to the appliance and/or be exposed to danger of electrocution.
- ⚠ Do not lean on the appliance.
- ⚠ In the event of water leaks, turn off the appliance and disconnect the electric power supply. Call the Technical Service Centre.
- ⚠ In case of replacement of parts, use only original parts.

INSTALLATION

2.1 Description

InnovApp is the application that allows you to manage the elements of your home system through your smartphone or tablet, directly from home or remotely. Through the application you can set commands to individual devices, rooms or directly to the whole house.

2.1.1 Main functions

- supervision and control via local or remote network
- customised summer and winter programming
- weekly time programming
- domestic hot water setting
- remote assistance

2.2 Configurable products

The devices that can be configured through the application are:

- conditioners
- fan coil

The InnovApp application can be used with:

Wall control

- EFA649
- EFB649
- ECA031
- ECB031

Controls on the appliance

- EWF644
- EWF647
- on-board display unit air conditioners

⚠ Individually configurable devices are those with a Wi-Fi connection. Directly connected devices cannot be managed individually by the application.

⚠ Devices with a Wi-Fi connection can only be configured using the app from your smartphone or tablet.

2.3 Downloading the application

2.3.1 Minimum requirements

In order to proceed with the download and installation of the application, some version requirements of the operating system of your smartphone are necessary.

For Android: minimum version 5.0 Lollipop (SDK 21)

For iOS: minimum version 11 (WKWebView)

For web:

Google Chrome: minimum version 68 (May 2018)

Mozilla Firefox: minimum version 54 (May 2018)

Opera: minimum version 55 (August 2018)

Safari: minimum version 11.1 (June 2018)

Microsoft Edge: minimum version 18 (November 2018)

- download and install the application

2.3.4 Web users

From your browser:

- access the following link <https://ambiente.innova-home.cloud/>.

2.3.2 Android users

On your smartphone or tablet :

- connecting to Play Store
- search for the InnovApp application
- download and install the application

2.3.3 iOS users

On your smartphone or tablet :

- connecting to the App Store
- search for the InnovApp application

PRELIMINARY SETTINGS

3.1 Preliminary warnings

- ⚠ Before starting to use the application make sure that:
- the appliance being configured is connected to the home network
 - in the case of appliances with WiFi connectivity, the signal reaches the appliance in a strong and stable manner

3.2 Access to the App

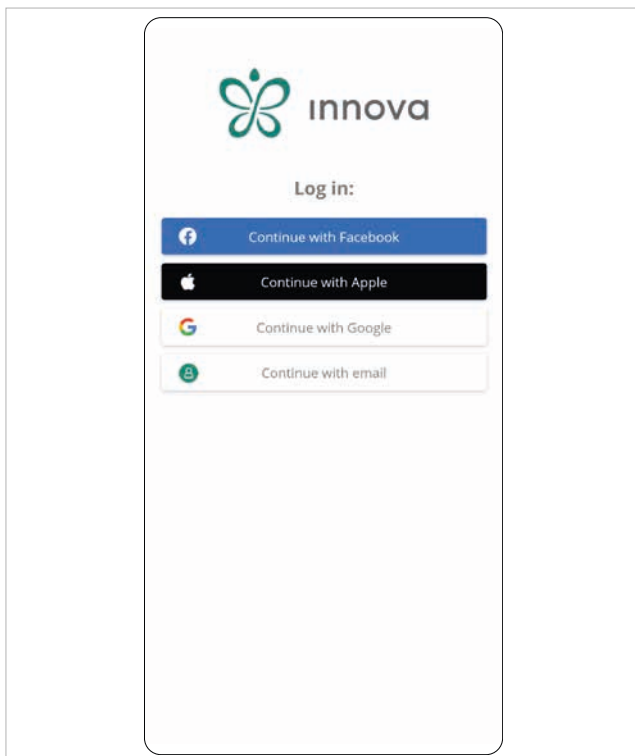

- ⚠ If you use the application for the first time, you will be asked to log in or register in order to continue.

To access

- open the application
 - log in or register
 - choose one of the proposed account types
- When registration is complete, the Add a new device screen appears.*

3.2.1 Registration through Facebook account

Selecting Continue with Facebook will open a window in which you can log in to the app using your Facebook account.

- enter your account credentials and password
- press login
- press Continue as if to complete the registration

- ⚠ When accessing the application for the first time using the account indicated, user registration will be carried out automatically.

3.2.2 Registration through Apple account

Selecting Continue with Apple will open a window in which you can login to the app using your Apple account.

- enter your Apple ID and account password
- press the arrow to continue

- ⚠ When accessing the application for the first time using the account indicated, user registration will be carried out automatically.

3.2.3 Registration through Google account

Selecting Continue with Google will open a window in which you can login to the app using your Google account.

- enter your account credentials and password
- press next to continue

- ⚠ You can create a new Google account by clicking on 'Create an account'. Follow the instructions that will be listed until the procedure is complete.

- ⚠ When accessing the application for the first time using the account indicated, user registration will be carried out automatically.

3.2.4 Registration by email

Selecting Continue with email will open a window in which you can log in with an already registered account.

When accessing the application for the first time, it is necessary to register an account.

- select Registration
 - complete the fields
 - select Registration again
- If you fill in the form correctly, you will receive a notification of successful registration.
A warning message will appear if there are any errors in the compilation.*

- proceeds to correct the information entered
 - select Registration again
- If you fill in the form correctly, you will receive a notification of successful registration.*

If you are accessing with an already registered account, please login

- enter your account credentials and password
- press login

⚠ When accessing the application for the first time using the account indicated, user registration will be carried out automatically.

3.2.5 Privacy consents

When accessing the application for the first time, the Privacy settings screen will be displayed.

In order to be able to take advantage of the application's functionalities, you must consent to the following Privacy consents:

- Personal data processing (mandatory)
- Data analysis (optional)
- Commercial communications (optional)

⚠ Consents can be changed at any time in the "User" [p. 33](#) section.

3.3 Configuration

In order to manage and control your appliances through the app, you need to configure them. The first time you access the app you will be asked to configure your appliance.

⚠ If there are several appliances, they must be added and configured individually.

⚠ Switch on and configure one appliance at a time to avoid errors.

⚠ Switch off appliances that are not being configured by switching them off or setting the WiFi of the control connected to the appliance to OFF. Refer to chapter "WiFi network On, Off and Reset" [p. 39](#) for instructions on WiFi settings.

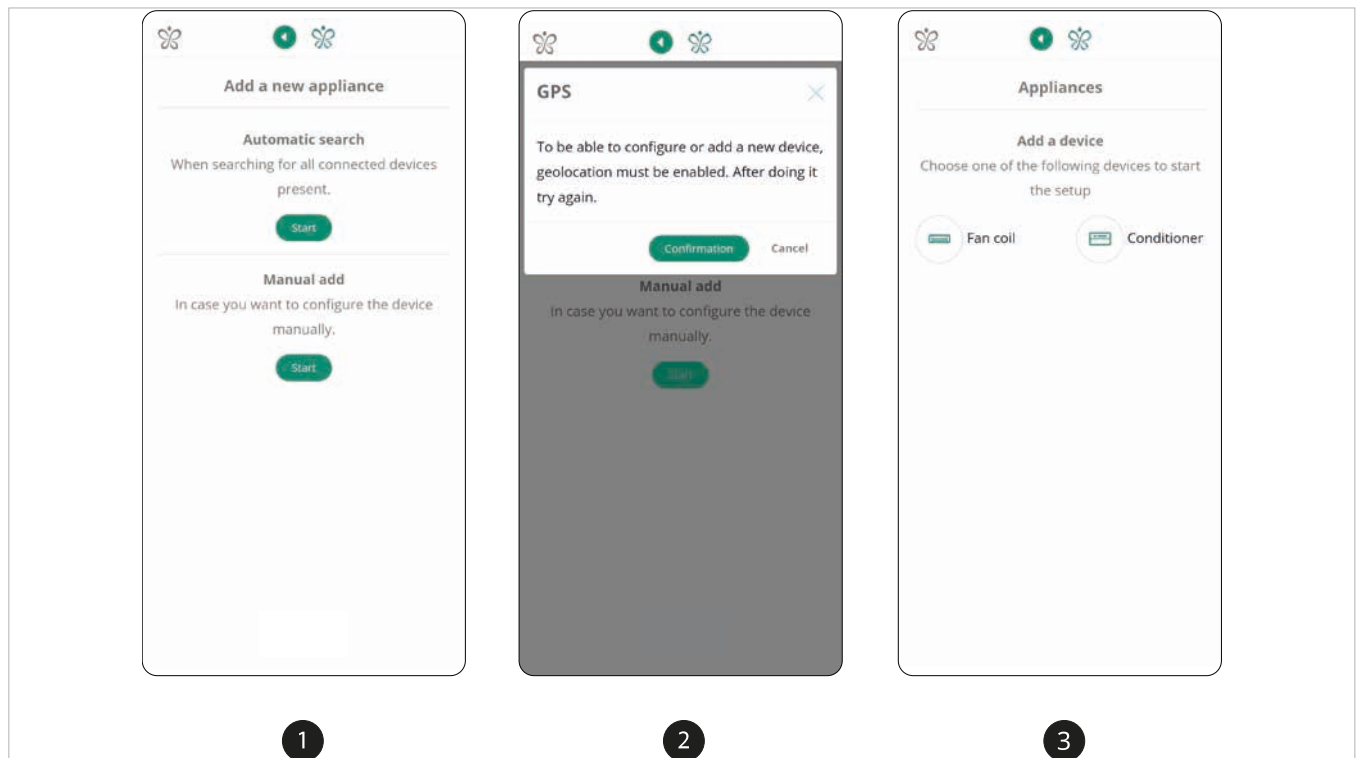

To configure

- select manual add
 - select start
- If the prompt to activate localisation appears in order to configure or add a new device, confirm the request to locate all connected devices.*

⚠ Localization activation. This function is indispensable for configuring your devices.

⚠ If you unintentionally press Reject, you will need to allow the use of location from your smartphone or tablet settings.

- select start again
- The screen for choosing the type of appliance to be configured appears.*

3.3.1 Fan coil configuration

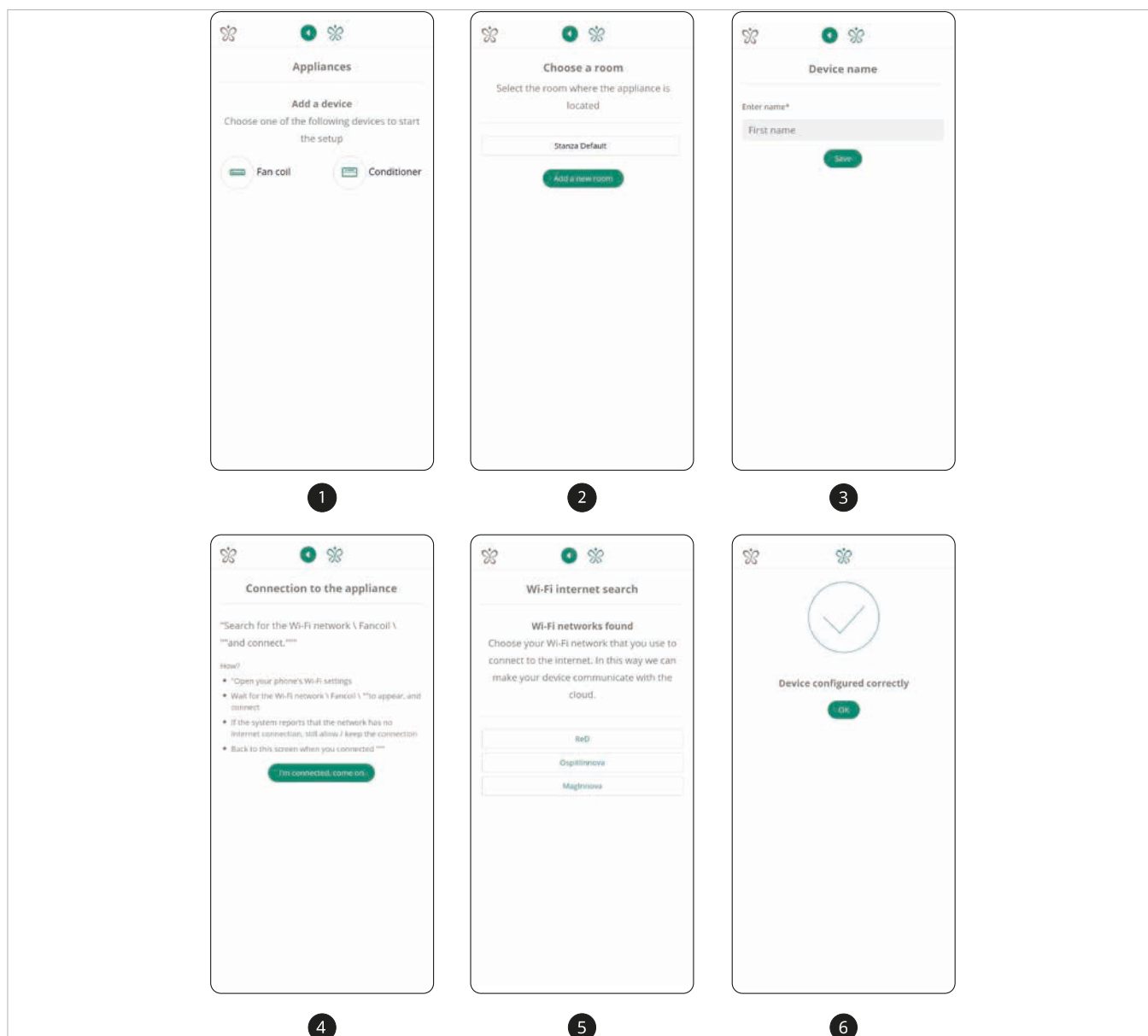

To configure

- select Fan coil
The screen for choosing the room to match the device being configured appears.
- select Room Default to match the appliance to the room
- select Add a new room to create a new one

⚠ Please refer to chapter "Manage rooms" [p. 28](#) for information about rooms.

This takes you to the screen for entering the name of the appliance.

- enter the name you want to give the device
- save
The Connection to appliance screen is accessed.
- follow the instructions
- connect to the WiFi network of the product you want to configure
- confirm
The application starts the connection to the appliance.

The screen with the list of available WiFi networks appears.

- select your WiFi network
- enter the password if any
- save

The application starts the connection to the appliance.

A successful configuration message appears.

- select OK
The main screen is accessed.

⚠ To configure a new device, follow the same procedure.

⚠ All added appliances are by default matched to the default Calendar with Comfort set and operate in Programming mode.

⚠ To change the programming, please refer to chapter "Planning" [p. 15](#).

3.3.2 Conditioner configuration

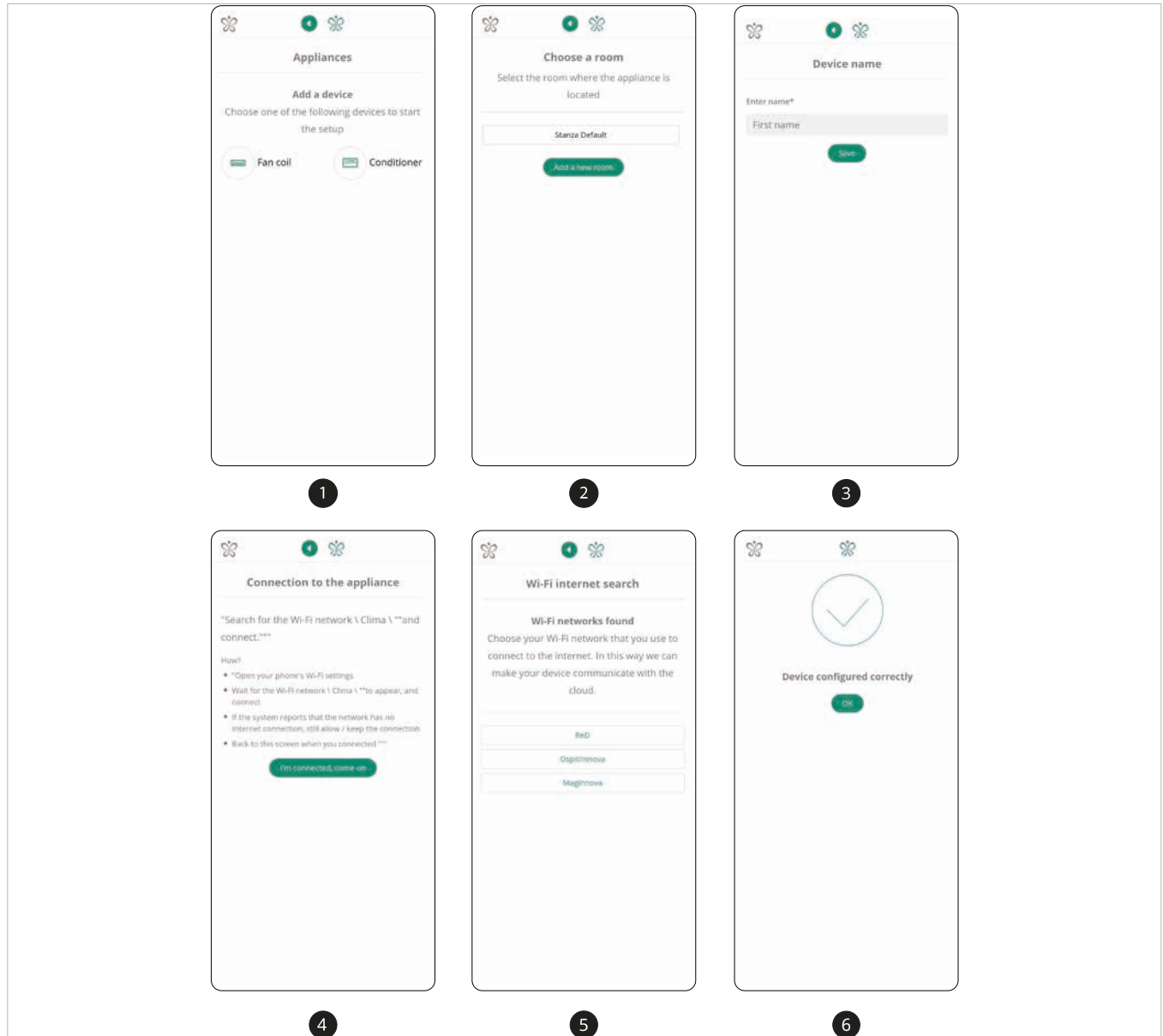

To configure

- select Conditioner
The screen for choosing the room to match the device being configured appears.
- select Room Default to match the appliance to the room
- select Add a new room to create a new one

⚠ Please refer to chapter "Manage rooms" [p. 28](#) for information about rooms.

This takes you to the screen for entering the name of the appliance.

- enter the name you want to give the device
- save
The Connection to appliance screen is accessed.
- follow the instructions
- connect to the WiFi network of the product you want to configure
- confirm
The application starts the connection to the appliance.

The screen with the list of available WiFi networks appears.

- select your WiFi network
- enter the password if any
- save

The application starts the connection to the appliance.

A successful configuration message appears.

- select OK
The main screen is accessed.

⚠ To configure a new device, follow the same procedure.

⚠ All added appliances are by default matched to the default Calendar with Comfort set and operate in Programming mode.

⚠ To change the programming, please refer to chapter "Planning" [p. 15](#).

BASIC SETTINGS

4.1 Main screen

4.1.1 Interface

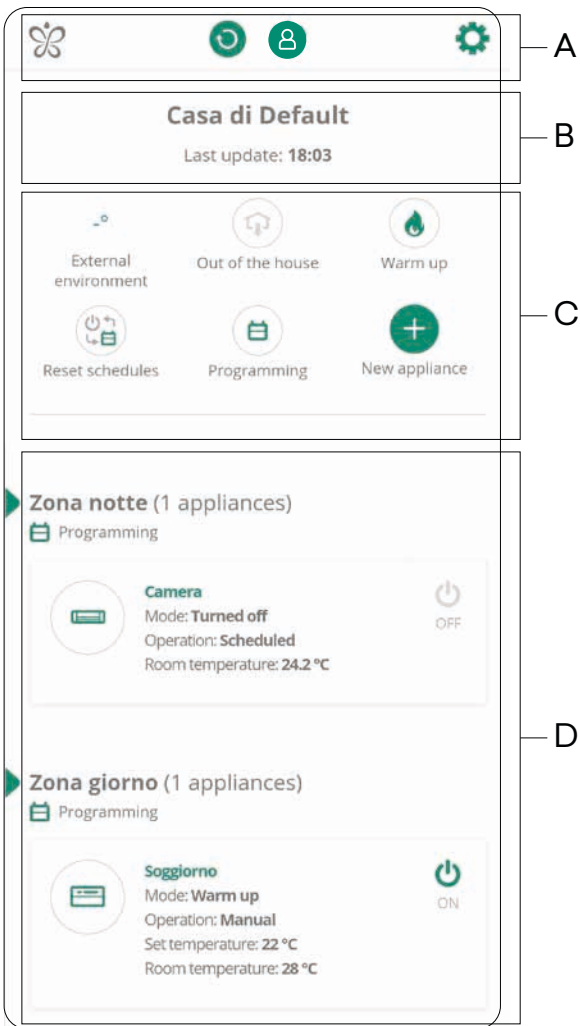

A: Navigation bar

- Home
- Go back
- Update
- Account
- General settings

The Account icon may have a different image depending on the connected account.

B: Information area

The name of the selected home and the time of the last update are displayed

C: Common function area

- External environment (not available for fan coils and conditioners)
- Out of the house function deactivated
- Out of the house function activated
- Heating Mode
- Cooling down Mode
- Switch off/reset programming function
- Planning function
- New device

Common functions are applied to all configured and connected appliances to the home.

D: Room and device management area

Rooms are displayed and individual appliances in the home are managed

4.2 Out of home function

This function allows you to manage your devices easily and optimally when you are away from home. When the Out of home function is activated, the application automatically activates special planning that overrides that of all configured devices. The duration of this setting is unlimited, once activated it remains always active until it is deactivated by selecting the icon on the main screen again.

The default settings for the Out of home set are:



- status: off
- room temperature - cooling: 28 °C
- room temperature - heating: 20 °C
- fancoil function: minimum (if there is at least one fan-coil in the house)

- air conditioning function: minimum (if there is at least one air conditioner in the house)



You can control and edit the settings of this function by editing the Out of home set in the Planning section.

To change the Out of the house set, follow the instructions in chapter "Programming of time slots and temperature sets" [p. 17](#).

4.2.1 Activation

- from the main screen
- select the  icon
A message confirming activation of the Out of home function appears.
- confirm
The Out of home function is activated.
The icon changes colour .

4.2.2 Deactivation

- from the main screen
- select the  icon
A message confirming deactivation of the Out of home function appears.
- confirm
The Out of home function is deactivated.
The icon changes colour .

4.2.3 Changing settings

The Out of home function activates the Out of home set in all calendars and keeps it active until the function is disabled.

4.3 Warm up/Cooling down mode

This function allows you to carry out the seasonal change of the entire house and all the appliances in it.

 If there are manually operated devices during the season changeover, the forcing is removed and the device resumes its programming.

 The only devices that are an exception to this rule are air conditioners that operate independently in their own mode (dehumidification, ventilation only, heating, cooling).

4.4 Switch off/Reset schedules function

It is possible to assign to one or more appliances commands other than those programmed by temporarily activating the manual functions. These functions can be activated in three ways:



Active for X hours: manually set operation remains active for the selected number of hours, after which the matched programming is automatically reactivated.

Active for X days: the manually set operation remains active for the selected number of days, after which the matched programming is automatically reactivated.

Always: manually set operation remains active until a new command is entered.



4.4.1 Activating Manual operation

To activate manual operation

- from the main screen
- select the  icon
The manual operation setting screen appears.
- select how long you want to deactivate programming and activate manual operation
- in case of activation for X days or X hours select the number
Manual operation is activated for all appliances.
The  icon changes.

4.4.2 Reset schedules

To reset schedules

- from the main screen
- select the  icon
Programming is reactivated for all appliances.
The  icon changes.

4.5 Planning

The application includes a calendar system that allows the week to be programmed for all the configured devices in the home.

Programmed operation enables organised and automatic management of the appliances.

A calendar can be assigned to a room or an appliance with a hierarchical system.

Room associated calendar: is applied to all contained devices (if they do not already have a combined calendar).

Calendar associated with the device: is applied to the individual device.

⚠ All added devices are matched to the default Calendar with Comfort setting by default.

4.5.1 Creating a calendar

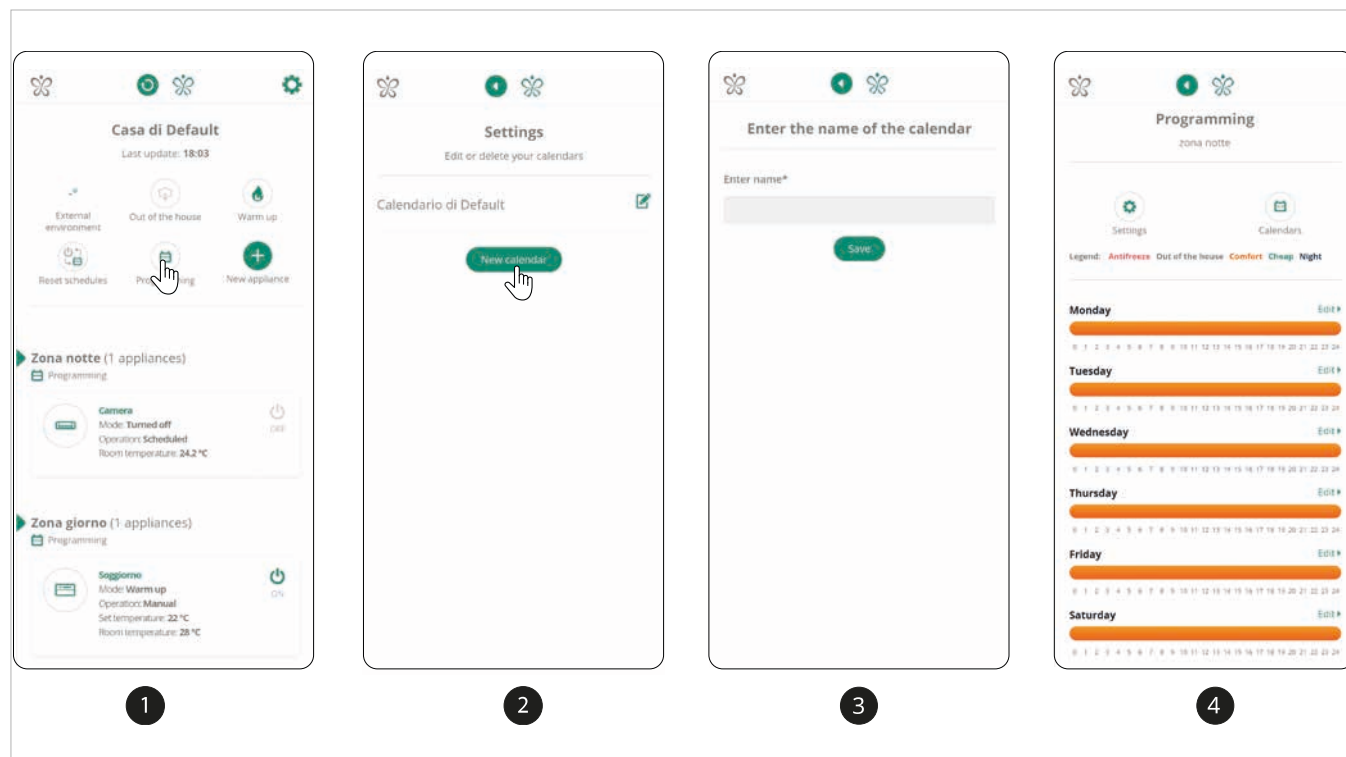

Calendars are a central element of the application, and it is possible to create more than one according to homogeneous zones by operating mode (e.g. night zone or day zone).

⚠ All added devices are matched to the default Calendar with Comfort setting by default.

To create a calendar

- from the main screen
- select Programming 
The screen with the list of calendars is accessed.
- select New calendar
This takes you to the name entry screen.
- enter the name you want to give the calendar
- save
The planning and calendar management screen is accessed.

4.5.2 Associating a calendar with appliances and rooms

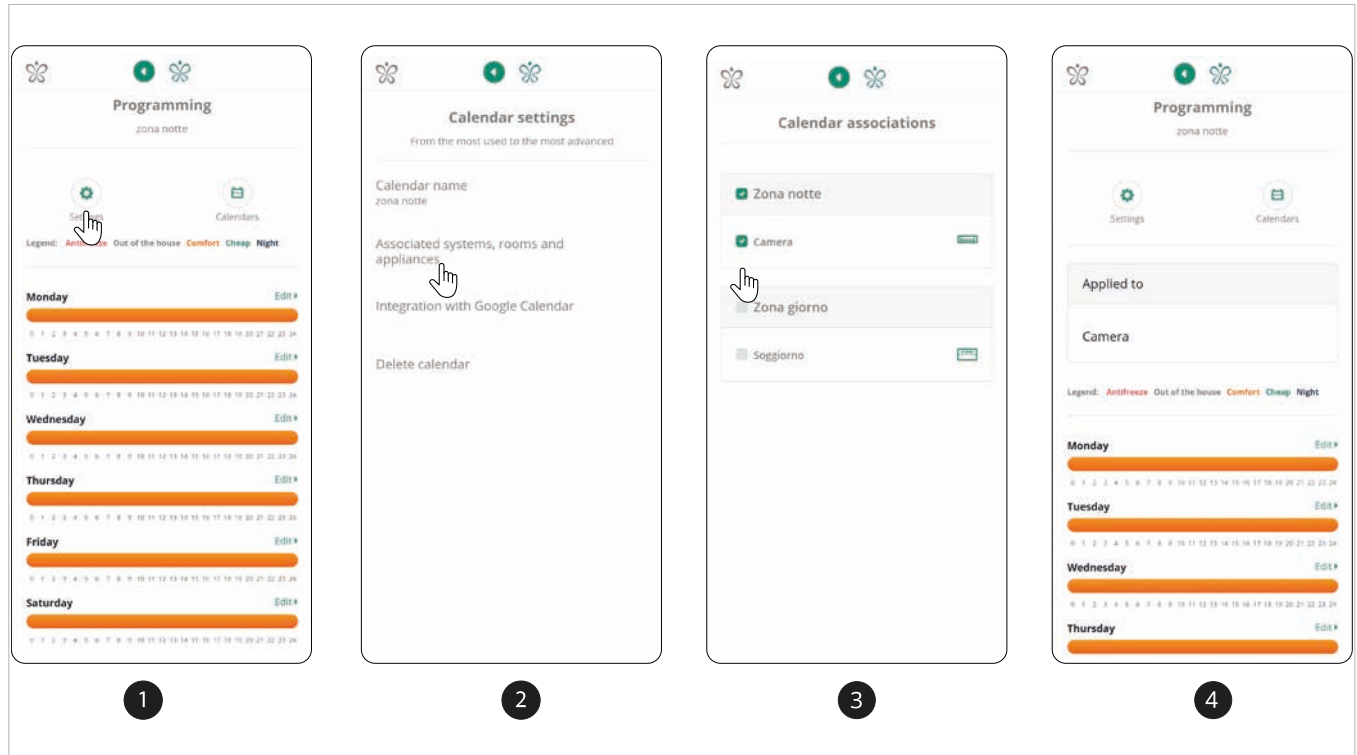

⚠ Before starting to schedule the calendar, it is necessary to match one or more devices and/or rooms to the calendar.

In this section you can match calendars to devices and rooms.

To associate

- from the scheduling and calendar management screen
- select Settings
- The specific calendar settings are accessed.*
- select Installations, rooms and associated devices
- select the rooms and/or appliances to be associated
- A tick appears next to the associated rooms and/or appliances.*
- return to the screen with the list of calendars
- The calendar is associated with the appliances.*
- A section appears with a list of the appliances to which the calendar is applied.*

⚠ Warnings:

- a calendar can be associated directly with a room or an appliance and is applied hierarchically to the elements below it (if they do not themselves have a calendar associated). E.g. if the calendar is associated with the room, it will consequently be applied to all the appliances in the room.
- the appliances inherit the calendar of the room containing them only if there is not already a matching calendar at the appliance level.
- the priority is therefore descending and detailed, the calendar of a device has priority over that of the room which in turn has priority over that of the home.

4.5.3 Programming of time slots and temperature sets

Interface

⚠ All added devices are matched to the default Calendar with Comfort setting by default.

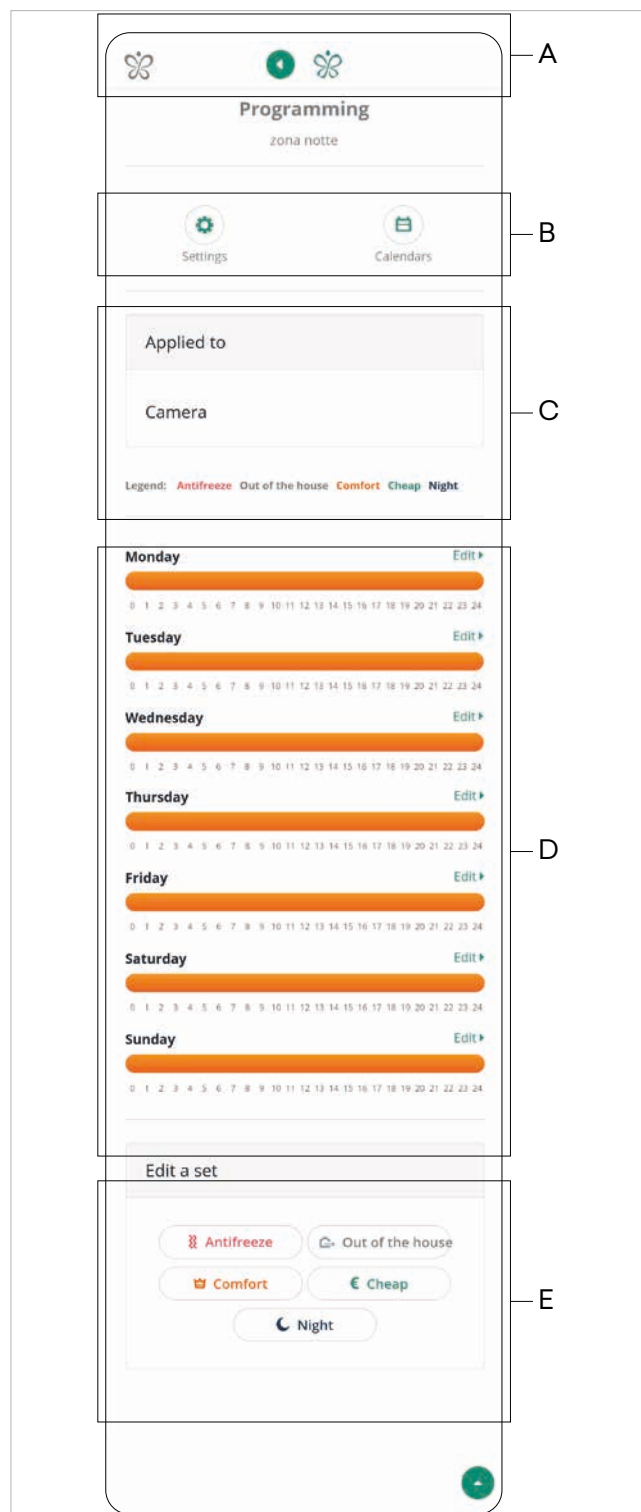

A: Navigation bar

- Home
- Go back
- Account
- General settings

B: Settings area

- Calendar settings
- Back to the list of calendars

C: Information area

Appliances associated with the calendar are displayed

D: Programming area

The weekly calendar schedule is displayed with the possibility of changing days and time slots

E: Set area

Allows you to modify set parameters

⚠ Each set corresponds to a visible colour in the planning.

Temperature set description

For each calendar there is a group of sets that allow a series of parameters to be programmed automatically to simplify temperature management for all the devices in the home. The predefined sets linked to each calendar are:

Antifreeze: set with special settings for winter or in case of low outside temperatures, to be set to avoid problems with cold weather

Out of home: set with special settings to manage the devices when away from home (this set is applied automatically in the out of home function)

Comfort: set with special settings for standard comfort management of devices (set active by default for calendars)

Eco: set with special settings for ECO management of devices

Night: set with special settings to manage the devices at night

Programming time slots

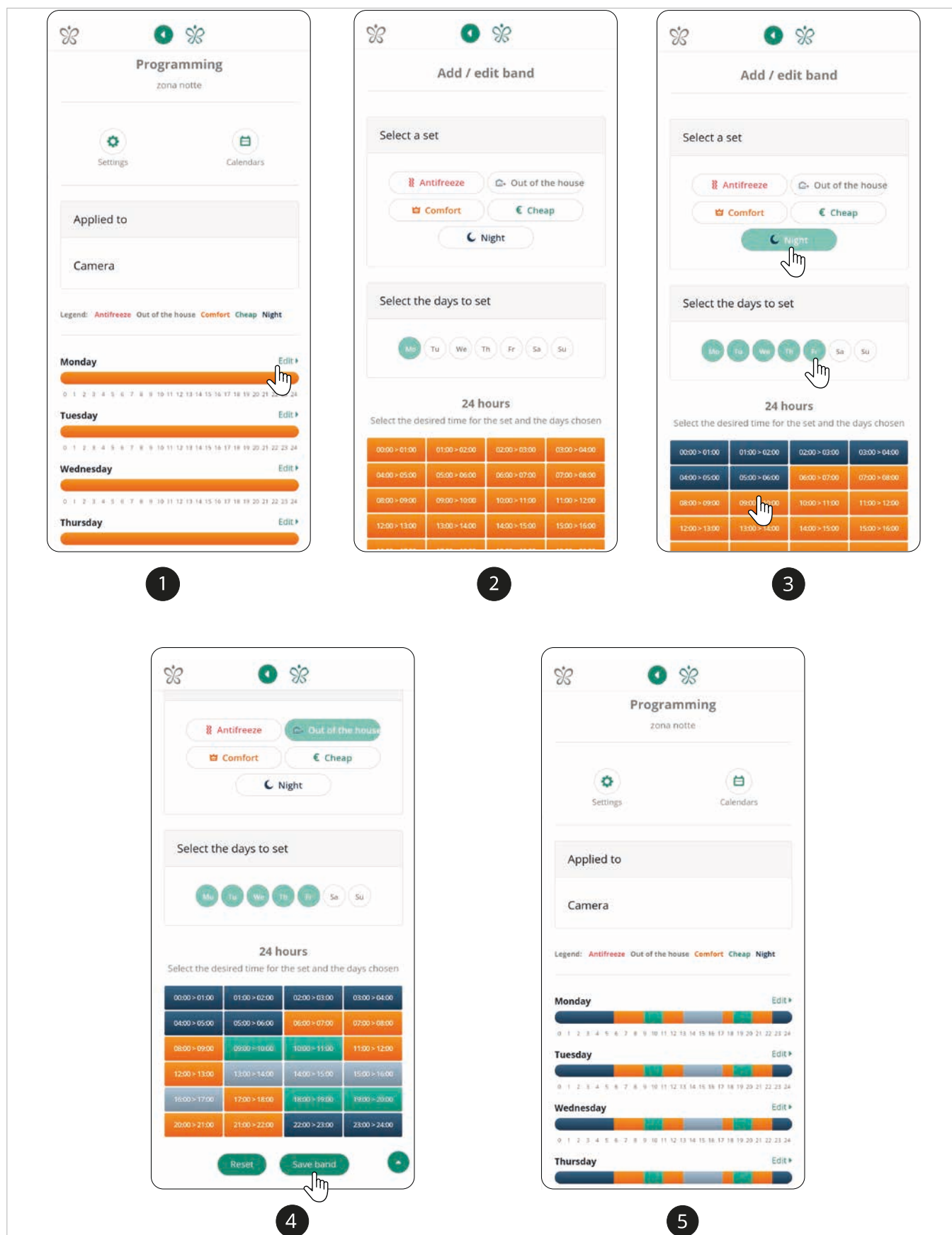

By pressing on modify a day of the week it is possible to set the planning for that specific day or extend it to other days of the week. The procedure involves selecting the set, the

days on which to schedule the set and the hours for which to activate the set.

To set planning

- from the scheduling and calendar management screen
- press edit a day of the week
The editing screen is accessed.

⚠ All added devices are matched to the default Calendar with Comfort setting by default.

- select the set to be added to the planning
- select all days to which to apply the set

⚠ By default, only the day previously selected in the planning screen is selected.

- select the time at which the set is to be activated
- press from/to when setting the set
- press a box twice if you want to set the planning to a single hour only
The interface will colour the time schedule with the colour of the set.
- proceed in this way for all the sets you want to add
- once the planning has been completed, select Save band to confirm the changes
- press reset to delete any scheduling
You return to the scheduling and calendar management screen.
Changes are applied to the calendar.

Modifying temperature sets

⚠ The settings are only visible if there is at least one device of the required type associated with the calendar.

To edit

- from the scheduling and calendar management screen
- select the set to be changed
The set-specific screen is accessed.
- select one of the settings
- make the change
A message of successful editing appears.
return to the scheduling and calendar management screen 
Set settings were changed.

Each set has a number of default settings that can be changed. By pressing on the set from the weekly view, you can access the list of parameters that can be set.

Status: device status on or off

Cooling room temperature: set-point for the summer season to be set with values from 5 to 40 °C

Heating room temperature: set-point for the winter season to be set with values from 5 to 40 °C

Fancoil function: fancoil specific function, Auto, Night, Minimum, Maximum operation

Air conditioning mode: function specific to air conditioners, operation Dehumidification, Ventilation only, Automatic heating/cooling, Default

Air conditioning function: specific function of air conditioners, Automatic, Minimum, Medium, Maximum operation

⚠ The entries listed identify all possible entries. Depending on the appliances associated with the calendar, it is possible to display more or fewer entries.

4.5.4 Deleting a calendar**To delete**

- from the screen with the list of calendars
- select the  icon next to the calendar to be deleted
A warning message appears.
- confirm the operation
You will return to the screen with the list of calendars.
The calendar is deleted from the list.

⚠ It is not possible to delete a calendar with associated appliances or rooms.

4.5.5 Calendar specific settings

In this section, calendar-specific settings can be managed and changed.

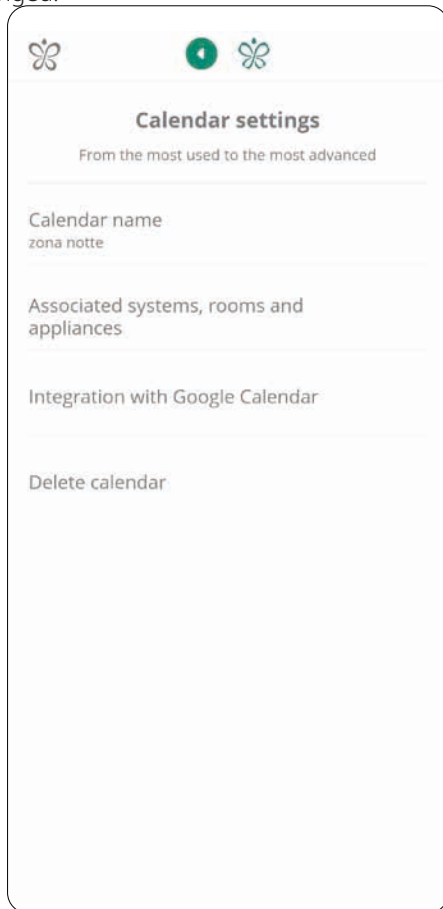

Calendar settings
From the most used to the most advanced

Calendar name
zona notte

Associated systems, rooms and appliances

Integration with Google Calendar

Delete calendar

Calendar name: allows you to change the name given to the selected calendar

Associated systems, rooms and appliances: allows one or more rooms and/or appliances to be associated with the selected calendar

⚠ To associate a calendar with an appliance or a room, follow the instructions in chapter "Associating a calendar with appliances and rooms" [p. 16](#).

Integration with Google: not available

Delete Calendar: allows you to delete the selected calendar

⚠ It is not possible to delete a calendar with associated appliances or rooms.

4.6 New device

This function allows other appliances to be configured after the first configuration.

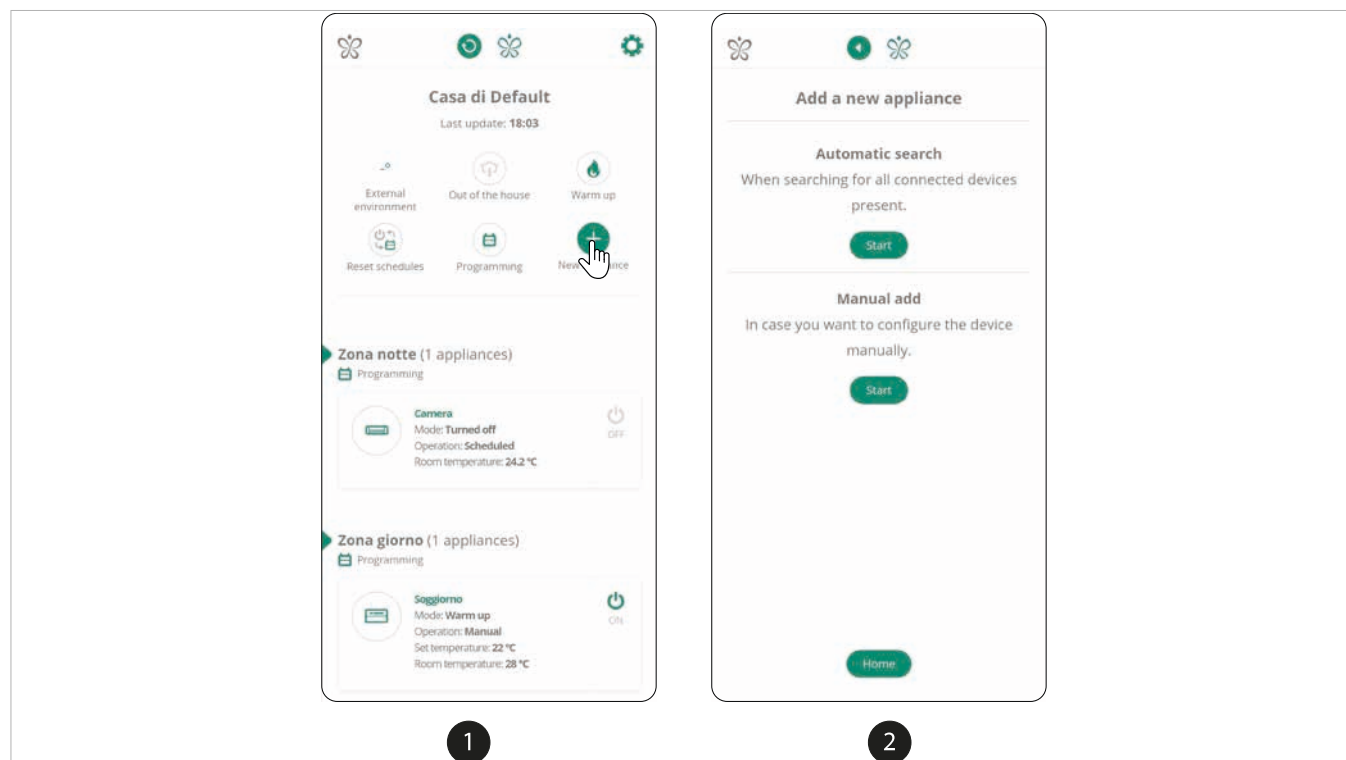

To configure

- select 
The configuration screen is accessed.
- choose the configuration mode

Add manually

It allows the first configuration of the appliances by setting the name, a room to associate them to, and connecting the appliances to the home WiFi network.

Automatic search

It allows the appliances to be configured automatically by connecting to the same WiFi network with which the appliances have been associated.

- ⚠ Only make an automatic search in the case of previously configured and accidentally deleted appliances.
- ⊖ Do not make an automatic search for the first configuration of an appliance.

4.6.1 Add manually

For the manual addition of an appliance, follow the instructions in chapter "Configuration" [p. 10](#).

4.6.2 Automatic search

⚠ Only make an automatic search in the case of previously configured and accidentally deleted appliances.

⊖ Do not make an automatic search for the first configuration of an appliance.

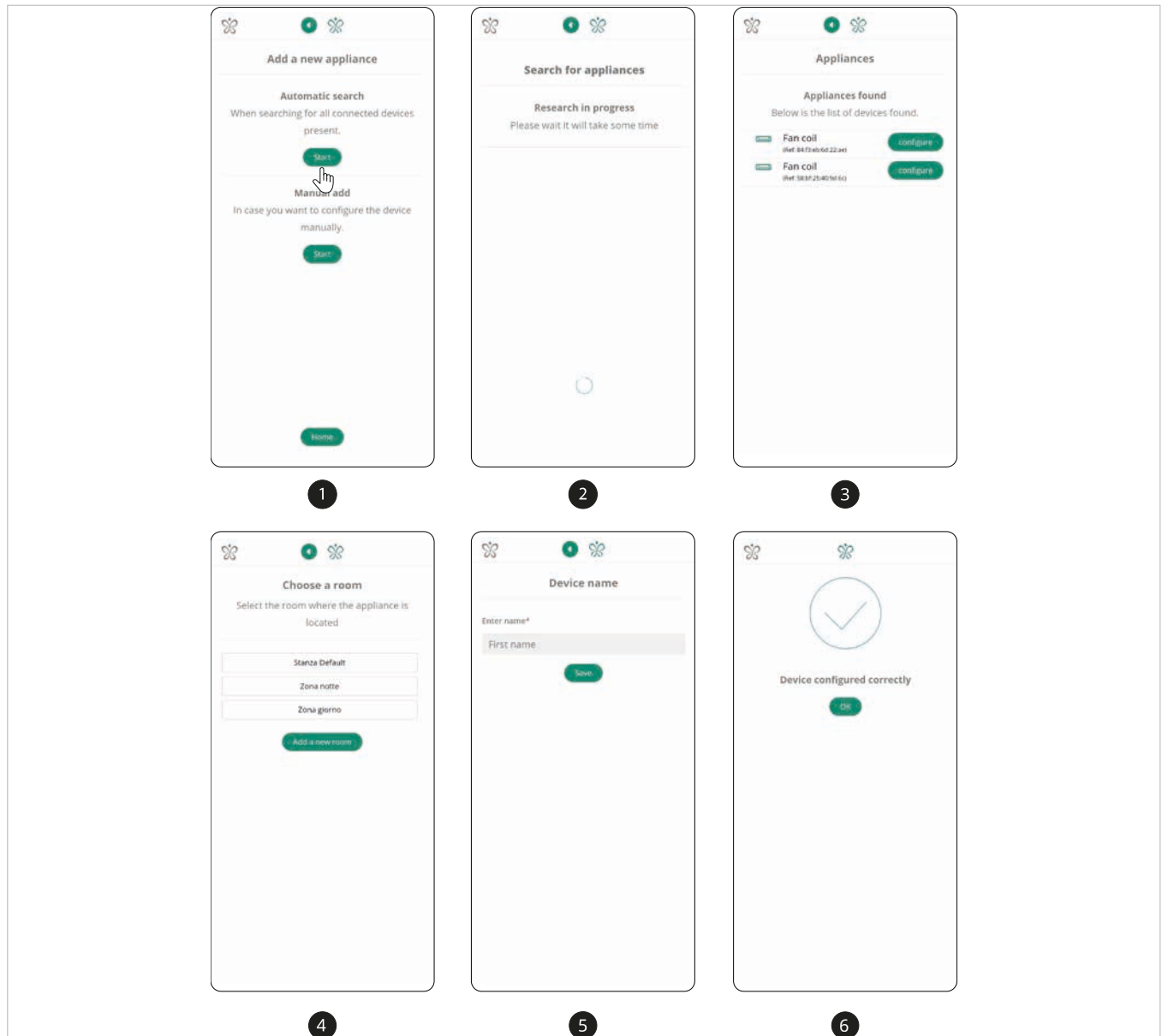

Automatic search

- select automatic search
The application automatically scans all appliances connected to the selected WiFi network.
The list of configurable appliances appears.
- select the appliance you want to configure
- identify the appliance by its serial number
- select configure
The screen for choosing the room to match the device being configured appears.
- select one of the listed rooms
- select Add a new room to create a new one

- enter the name you want to give the device
- save
The application starts the connection to the appliance.
A successful configuration message appears.
- select OK
- You return to the screen with the list of configurable appliances.
- select + to return to the main screen
The main screen is accessed.

⚠ Please refer to chapter "Manage rooms" [p. 28](#) for information about rooms.

This takes you to the screen for entering the name of the appliance.

GENERAL SETTINGS

5.1 General settings

5.1.1 Interface

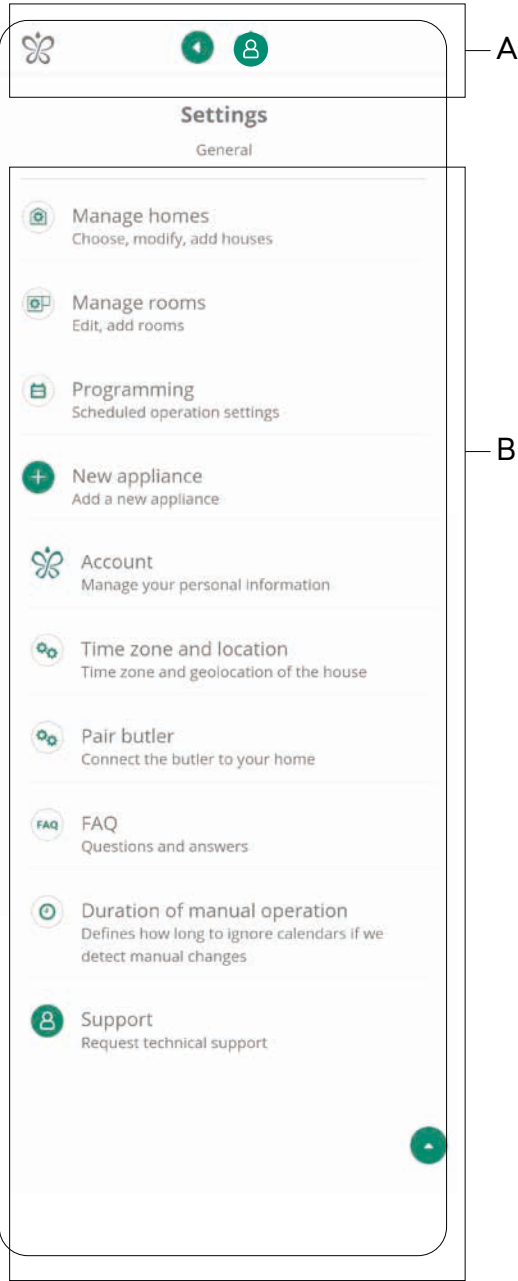

A: Navigation bar

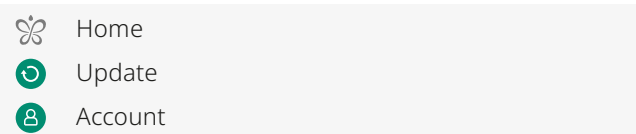

⚠ The Account icon may have a different image depending on the connected account.

B: General settings

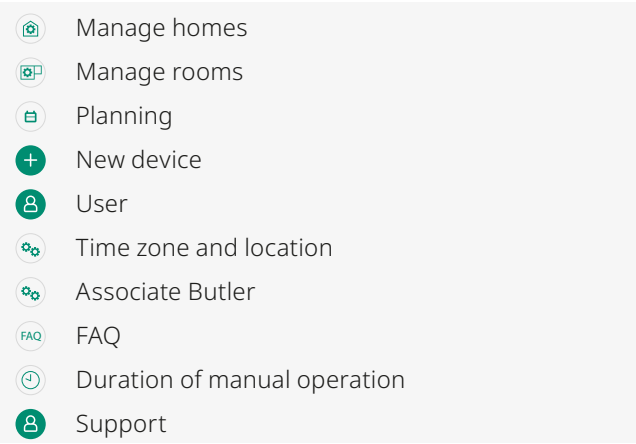

5.1.2 Description

Manage homes: allows you to create, edit, share or delete your homes and change the home manager.

Manage rooms: allows you to create, modify or delete rooms in the selected home.

Planning: allows you to access the management of your calendars, create new ones, edit or delete existing ones.

New device: allows access to the functions of automatic search and add manually of new devices to be configured.

Account: allows you to access to the account settings.

Time Zone and Location: allows you to change your time zone and location automatically or manually.

Pair butler: function not available.

FAQ: function not available.

Manual operation duration: allows you to define how long to ignore calendars in case of manual changes.

Support: allows you to send a request to the Support Team in case of problems.

5.2 Manage homes

A home can represent either a whole building or a flat composed of rooms. With this functionality it is possible to: create, edit, share or delete one or more homes.

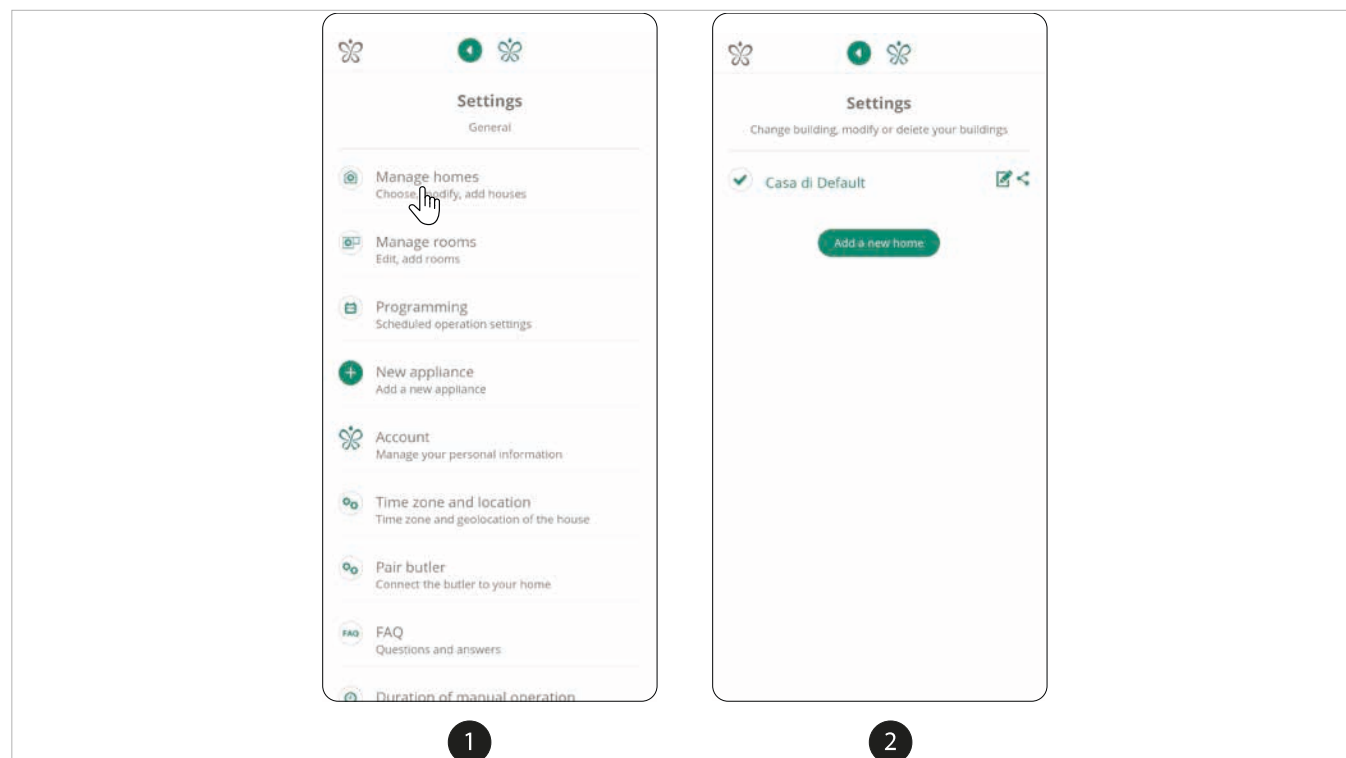

To access

- from General settings
 - select Manage homes
- This takes you to the home management section.*

5.2.1 Add a new home

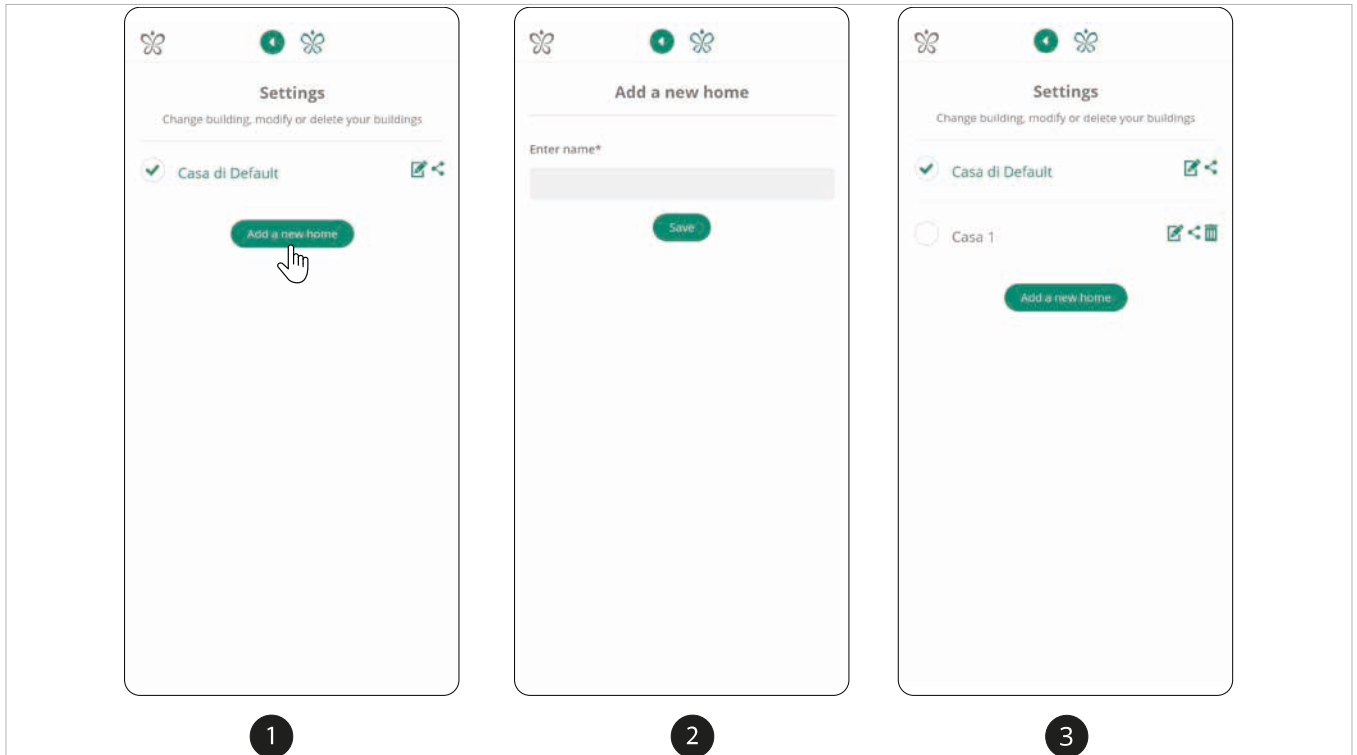

- from the house management screen
- select Add a new home
This takes you to the name entry screen.
- enter the name you want to give the new home
- save
*You return to the screen with the list of homes.
The newly created home appears in the list.*

- ⚠ The new home is created empty, without rooms and appliances. To use the functions, it is then necessary to configure the appliances and create the rooms within the new home.
- ⚠ To configure a new appliance, follow the instructions in chapter "New device" [p. 21](#) in the Basic Settings section.
- ⚠ For the creation of new rooms follow the instructions in chapter "Manage rooms" [p. 28](#).

5.2.2 Select the home to be displayed

In the list of homes, the home displayed in the application is the one selected with a green tick.

To display a different home in the list:

- select the house you want to view
A warning message appears.
- select confirmation to proceed
The main screen of the selected home appears.

5.2.3 Change the name of a home

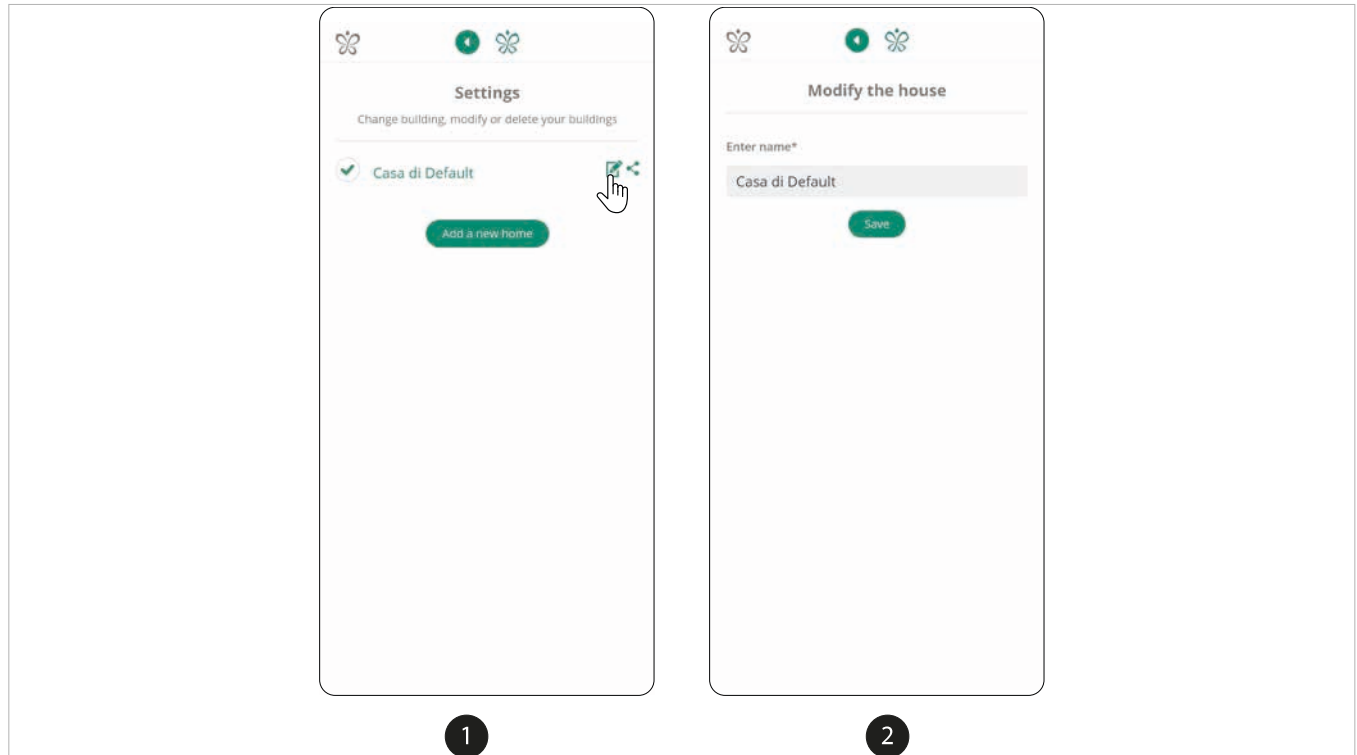

- from the house management screen
- select  next to the home you wish to modify
The screen for editing the name is accessed.

- edit home name
- save
*You return to the screen with the list of homes.
The new name appears in the list.*

5.2.4 Sharing a home

You can share a home with other users, add new guest users or managers.

Guest users: can only view and manage the home

Manager users: can view, manage and share the home with other users

 To share a home, the user must have downloaded the App and be registered.

 It is not possible to share the home or add unregistered users to the App.



Add user

To add

- from the house management screen
- select  next to the home you want to share
This takes you to the user management screen.
- enter the e-mail address of the user you want to add
- select add user
A warning message appears.
- confirm
*The home is shared with the new user in guest mode.
The new user appears in the user list.*



Change owner

To change the type of user

- from the house management screen
- select  next to the home you want to share
This takes you to the user management screen.
- select  next to the guest user you want to edit
A warning message appears.
- confirm to modify the user
*You return to the user management screen.
The user type is changed.*

Remove user

To delete

- from the house management screen
- select  next to the home you want to share
This takes you to the user management screen.
- select 
A warning message appears.
- confirm to remove the user
The user is removed from the list.

5.2.5 Delete the house

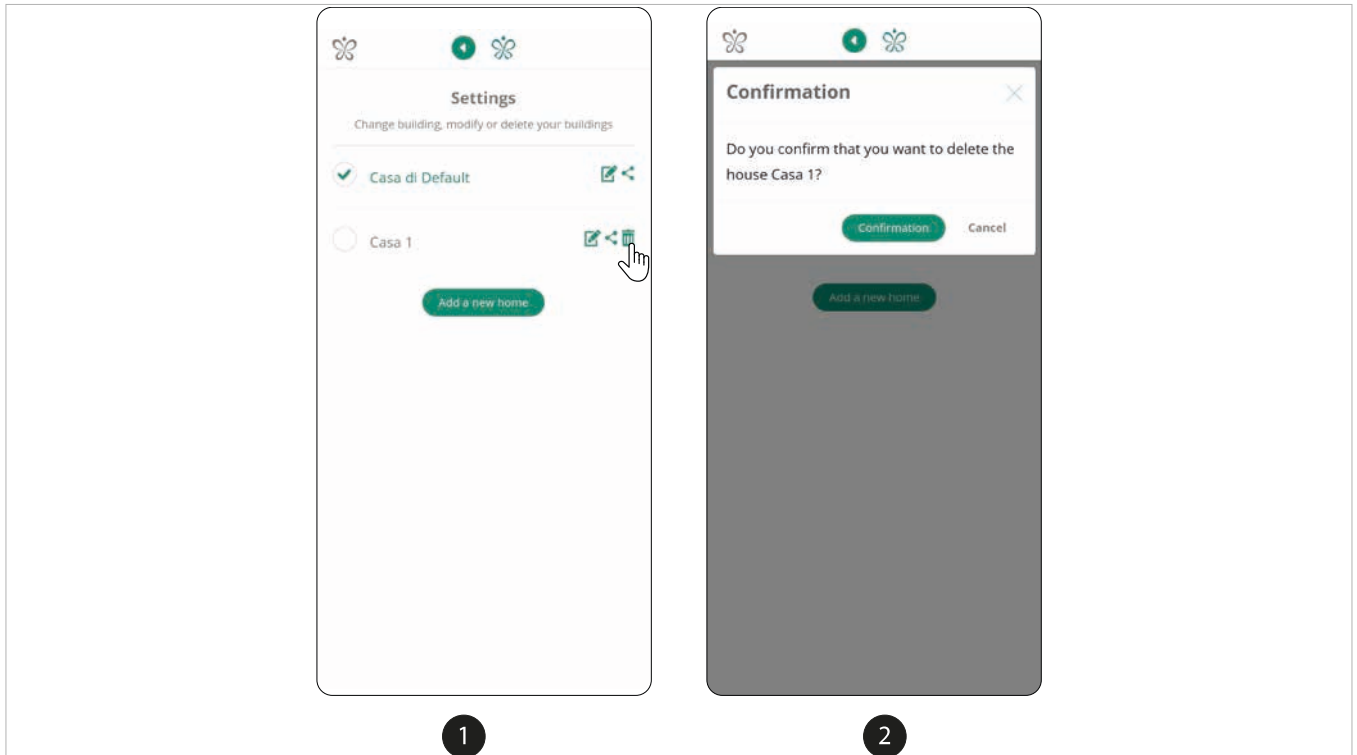

- from the house management screen
- select the  icon next to the home to be deleted
A warning message appears.
- confirm the operation
*You return to the screen with the list of homes.
The home is deleted from the list.*

 It is not possible to delete a home with devices configured inside.

 It is not possible to delete all homes in an account.

5.3 Manage rooms

In this section, the rooms in the house can be recreated and the existing devices can be positioned. In this section you can view the list of all rooms in the current home, create, edit or delete rooms.

By "room" is intended a container that can be:

- an entire floor of the house
- a room or space
- a specific environment

E.g. Room = ground floor where the appliances named "Kitchen", "Bathroom" and "Living room" are configured inside...

Room = 'Living' room where the devices named Fan coil 1, 2, 3 ... are configured inside.

Room = 'Night zone' environment where the devices named 'Bedroom', 'Bathroom' ... are configured inside.

⚠ Home management is free and can be set by the user as desired.

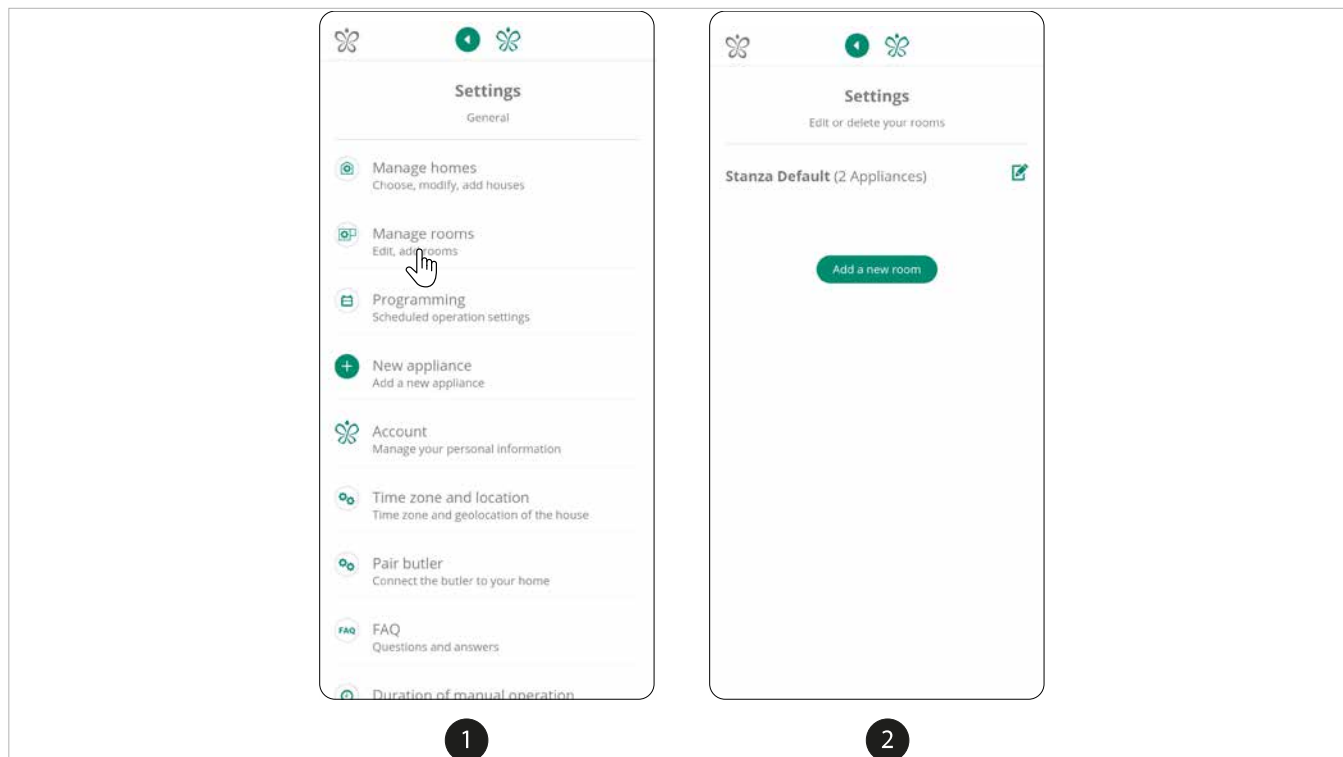

To access

- from General settings
 - select Manage rooms
- This takes you to the room management section.*

5.3.1 Add a new room

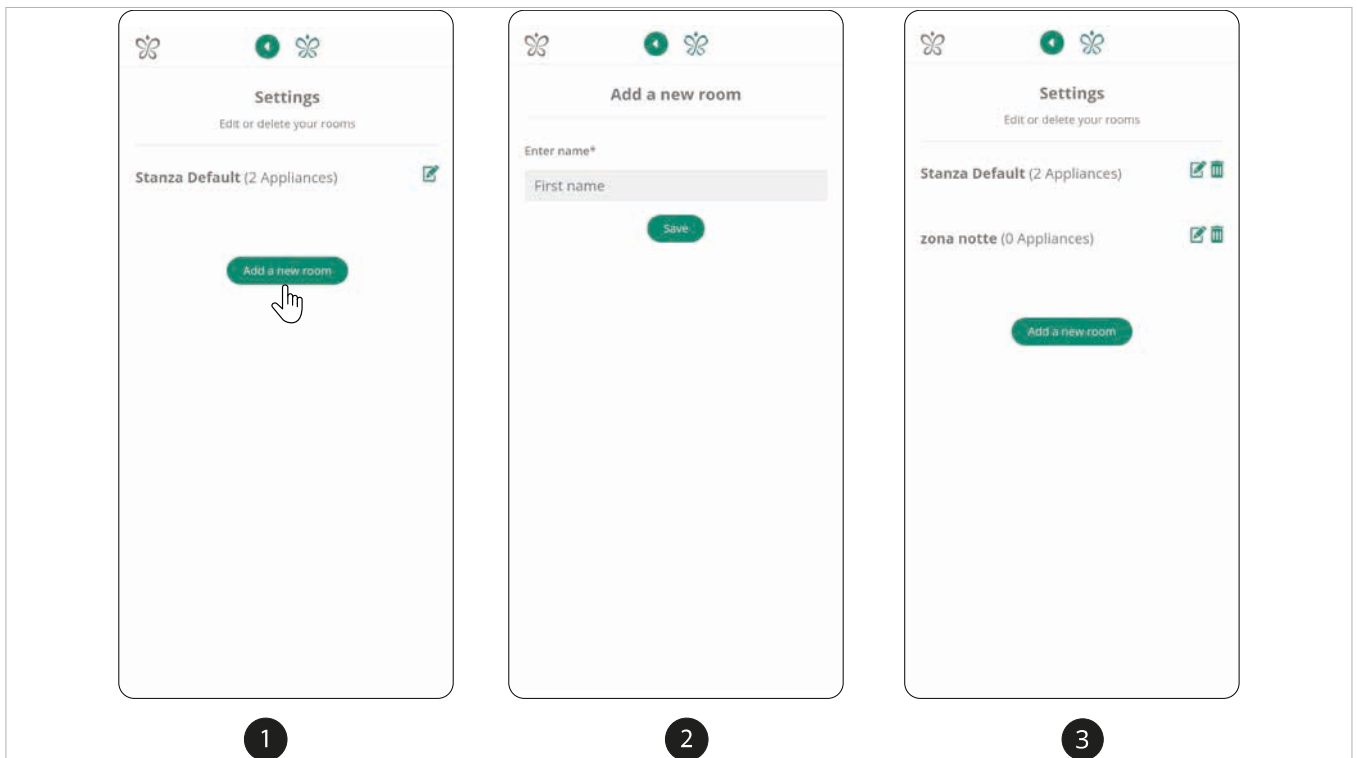



- from the room management screen
- select Add new room
This takes you to the name entry screen.
- enter the name you want to give the room
- save
*You will return to the screen with the list of rooms.
The newly created room appears in the list.*

⚠ The room is created empty. To add appliances to the room, please refer to "New device" [p. 21](#).

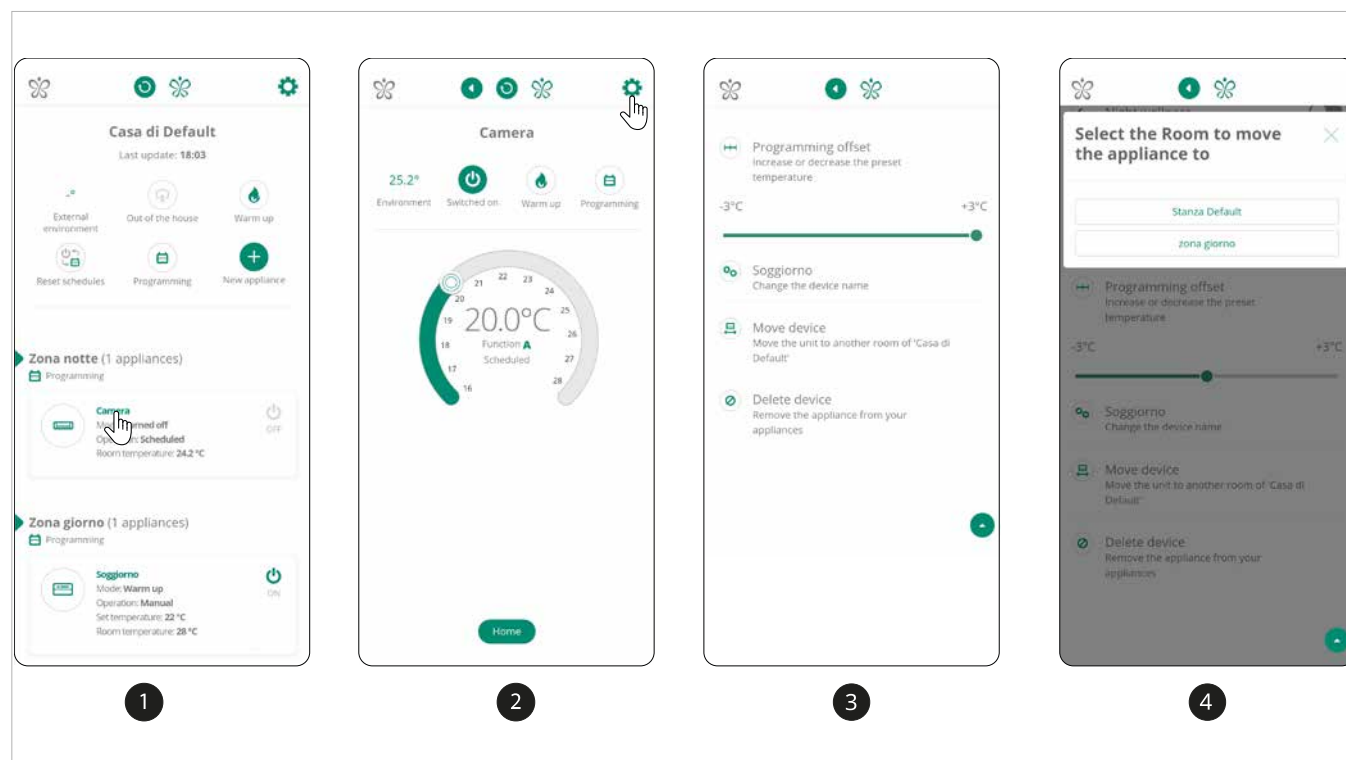
Associating an appliance with a room



To configure rooms

- from the main screen
- select the appliance you want to add to the room
The specific screen of the single appliance is accessed.
- select 
The appliance-specific settings are accessed.
- select 
A list of available rooms appear
- select the room to match the luminaire
You return to the main screen.
The appliance appears inside the room.

5.3.2 Change the name of a room

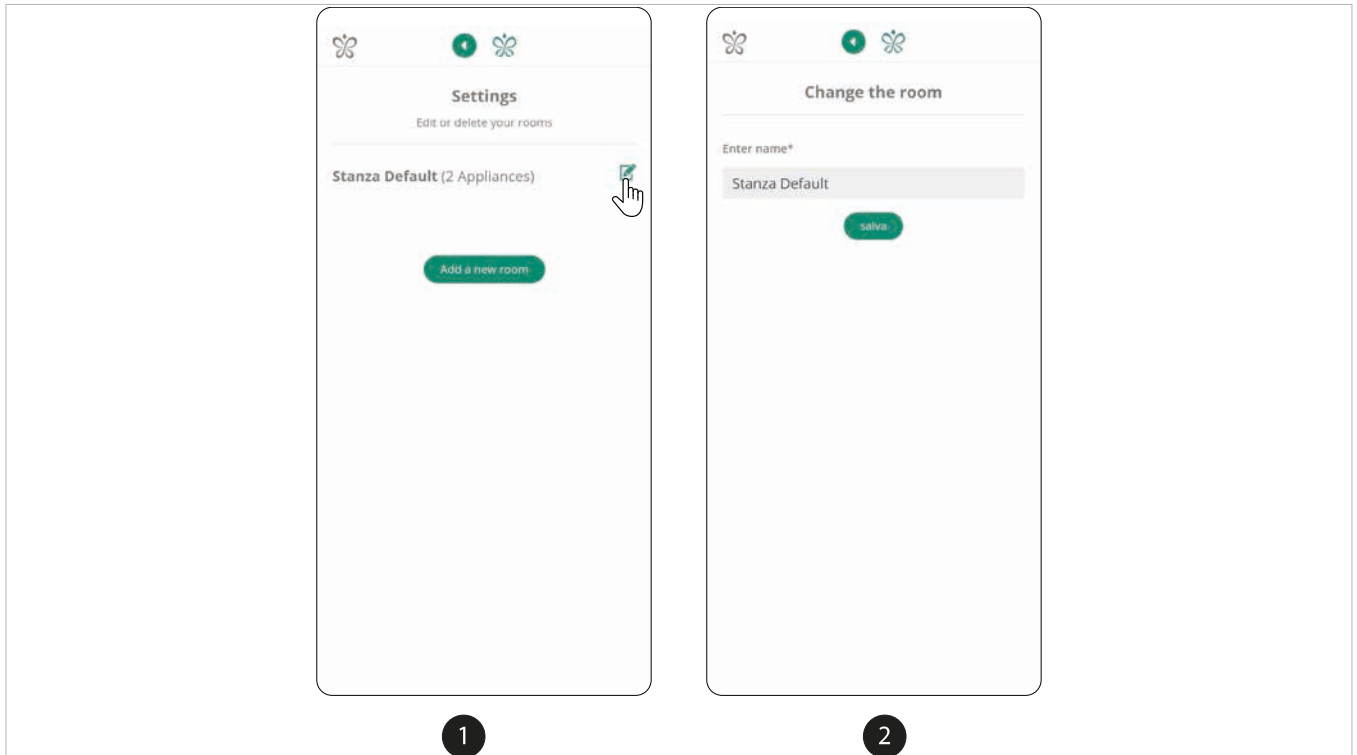

- from the room management screen
- select  next to the room you want to modify
The screen for editing the name is accessed.
- change the room name
- save
*You will return to the screen with the list of rooms.
The new name appears in the list.*

5.3.3 Deleting a room

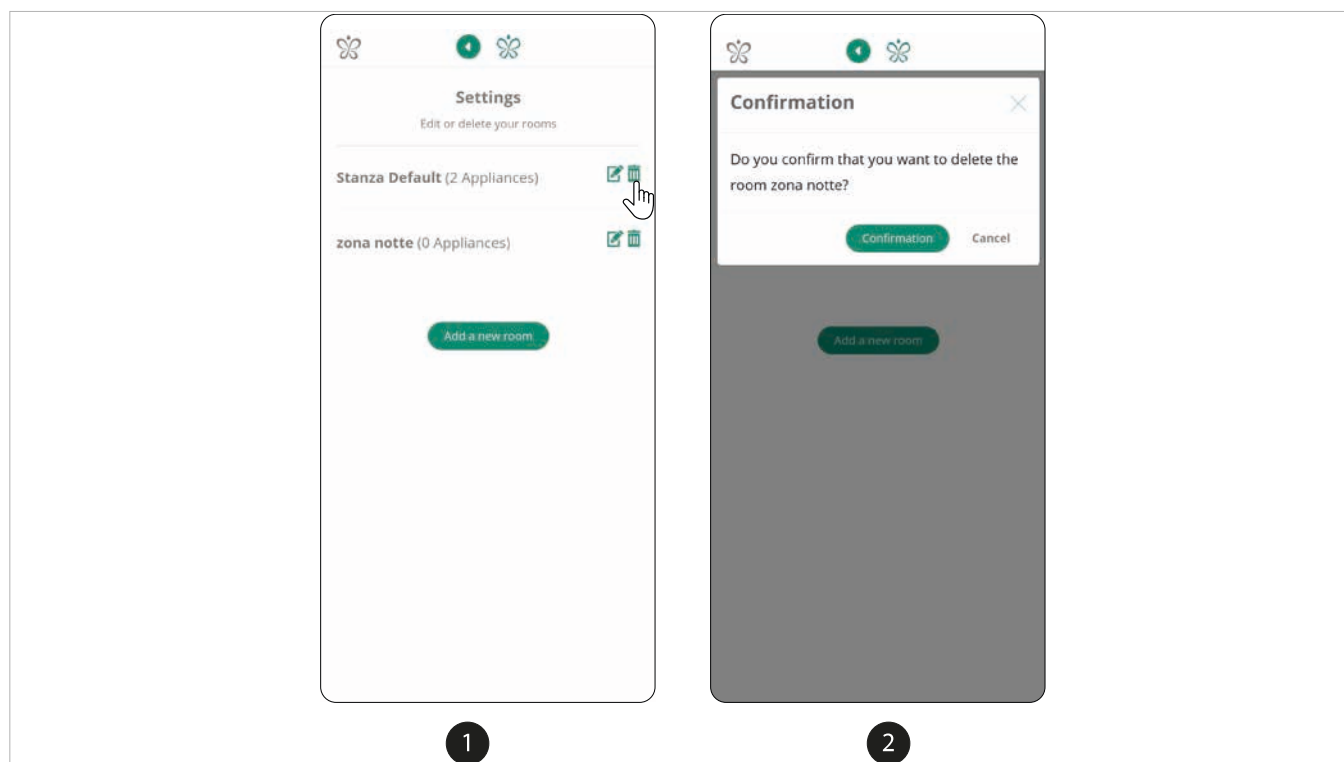

- from the room management screen
- select the  icon next to the room to be deleted
A warning message appears.
- confirm the operation
You will return to the screen with the list of rooms.

The room is deleted from the list.

- ⚠ If a room containing one or more devices is deleted, they will automatically be moved to another room.
- ⚠ It is not possible to eliminate all rooms in a home.

5.4 Planning

For calendar settings, follow the instructions in chapter "Planning" [p. 15](#) in the Basic Settings section.

5.5 New device

To configure a new appliance, follow the instructions in chapter "New device" [p. 21](#) in the Basic Settings section.

5.6 User

In this section you can manage and edit certain data of your personal account.

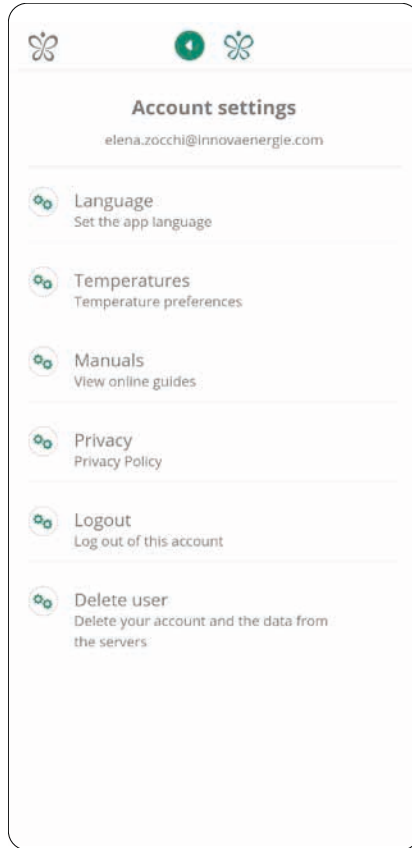

A: Account settings

- Language
- Temperatures
- Manuals
- Privacy
- Logout
- Remove user

To access

- from General settings
 - select Account
- The account settings are accessed.*

⚠ Account settings can also be accessed directly from the home screen by selecting the icon, see chapter "Main screen" [p. 13](#).

⚠ The Account icon on the main screen may have a different image depending on the connected account.

5.6.1 Language

Allows you to change the language of the application by choosing one of those available.

To edit

- select Language
 - select desired language
- The language is changed and you return to the main screen.*

5.6.2 Temperatures

Allows you to change the temperature unit between Celsius and Fahrenheit.

5.6.3 Manuals

Allows you to view and consult the user manuals for each category of appliance.

5.6.4 Privacy

Allows you to view the privacy policy and change your consent.

5.6.5 Logout

Allows you to log out of the current account.

- select Logout
 - confirm to continue
- The home screen for accessing the application appears.*
To use the app again, you must log in.

5.6.6 Delete user

Allows you to delete the user account and all related data. Deleting the user account deletes all connected houses, rooms and appliances.

⚠ The operation is irreversible.

5.7 Time zone and location

In this section you can change and select your time zone and location.

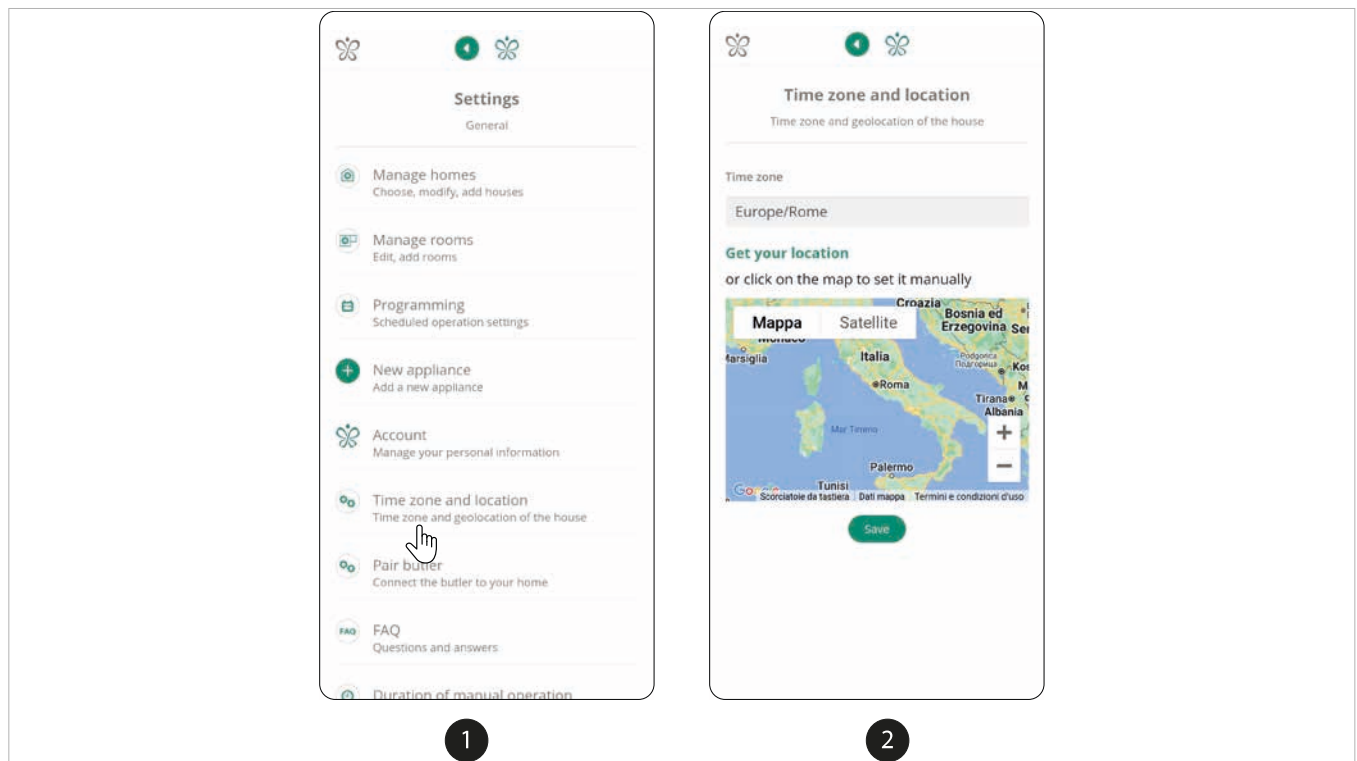

To access

- from General settings
 - select Time zone and location
- The time zone and location setting screen is accessed.*

5.7.1 Time zone

To set the time zone

- enter the continent you are on
 - *Compare a list.*
 - select the correct time zone
 - save
- The time zone is set.*

5.7.2 Position

It is possible to locate the home in two ways:

- automatic
- manual

⚠ Automatic geolocalisation is only performed if the position on the smartphone or tablet is active.

⚠ To geolocalise the home automatically, activate the location on your smartphone or tablet.

Automatic geolocation

- select Get your position
- *A warning message appears.*
- allow the app to access the location of the device
- *A confirmation message appears, position found.*
- *The pointer is positioned correctly.*

- save

Manual geolocation

- manually select a point on the map
- touch where you want to place the pointer
- *The pointer is positioned at the required place.*
- save

5.8 Duration of manual operation

In this section you can set a duration for manual operation.

The value indicates how long (hours) the calendars will be ignored if a user change is recorded directly on the device.

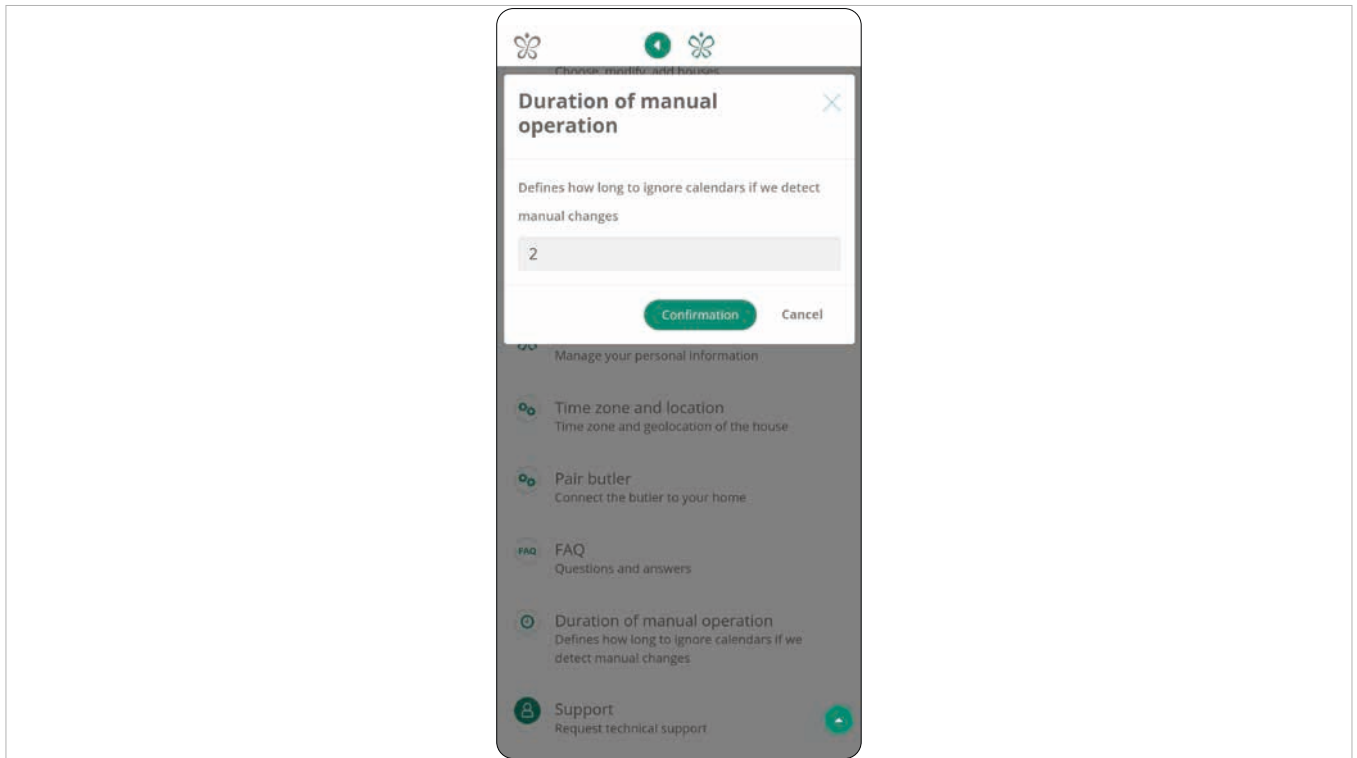

5.9 Support

In this section you can request technical support if you have problems configuring your devices.

- follow the procedures indicated on the display
- select Collect information to record the data needed by the Support Team to respond to your request
The main screen is accessed.
- repeat the operation that was giving problems
If the problem persists, go back to the support section.
- select 
- select Support
- describe the problem in detail
- select send to send your request to the Support Team

DEVICE SPECIFIC COMMANDS

6.1 Device specific commands

There are specific commands for each configured device.

To access

- from the main screen
- select one of the products

The specific screen of the single appliance is accessed.

⚠ Specific commands differ depending on the device selected.

6.1.1 Interface

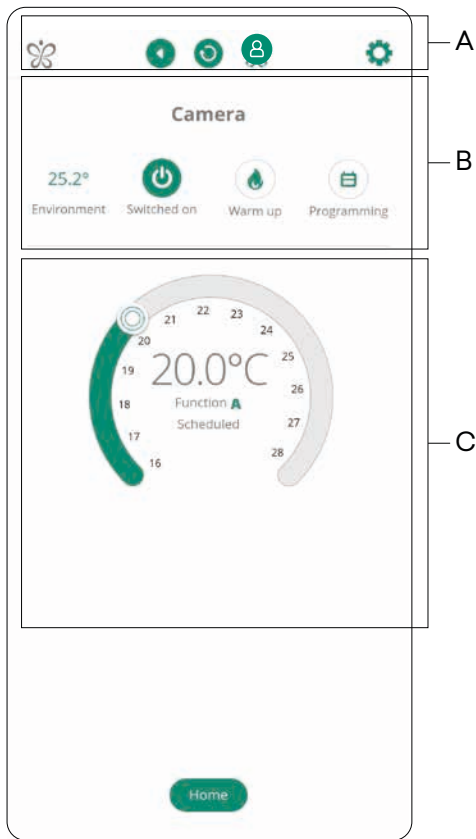

A: Navigation bar

Home

Update

Go back

Account

Device specific settings

⚠ The Account icon may have a different image depending on the connected account.

B: Specific functions area

Device name

20.0° Ambient temperature referring to the device

Appliance switched on

Appliance switched off

Dehumidification Mode

Ventilation only mode

Heating/cooling automatic

Default Heating Mode

Default Cooling Mode

Planning

⚠ The operating mode can only be set for conditioners.

⚠ For fan coil units, the operating mode can be changed from the Common Function Area in the Main Screen. Refer to the "Warm up/Cooling down mode" [p. 14](#) chapter for instructions.

C: Information area

The set temperature, function and operating mode (programmed or manual) specific to the device are displayed.

⚠ The listed entries identify all possible entries. Depending on the configured devices, more or fewer entries can be displayed.

6.2 Device-specific settings

6.2.1 Interface

1. Specific fan coil settings

①

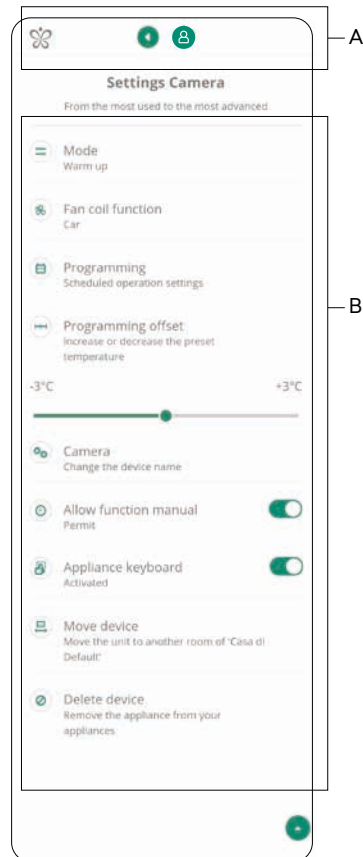

2. Specific conditioner settings

②

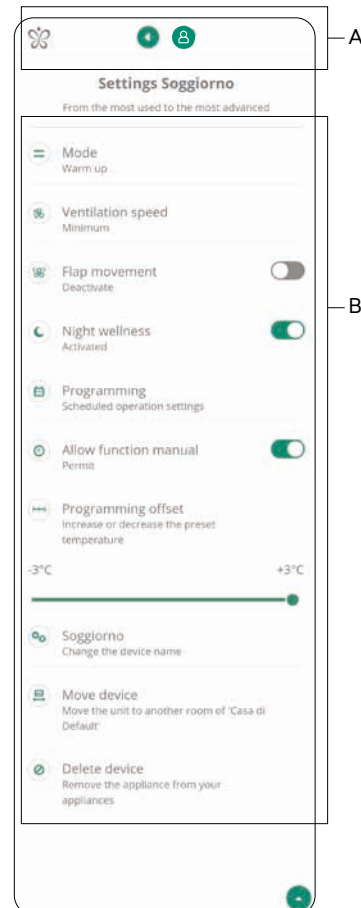

A: Navigation bar

- Home
- Go back
- Account

The Account icon may have a different image depending on the connected account.

B: Device specific settings

- Mode
- Fan coil function
- Ventilation speed
- Flap movement
- Night comfort
- Planning
- Allow function manual
- Offset programming
- Device name
- Device keyboard
- Advanced settings
- Move device
- Delete device

6.2.2 Description

⚠ The listed entries identify all possible entries. Depending on the configured devices, more or fewer entries can be displayed.

Mode: allows the operating mode of the device to be set.

⚠ The operating mode can only be set for conditioners.

⚠ For fan coil units, the operating mode can be changed from the Common Function Area in the Main Screen. Refer to the "Warm up/Cooling down mode" [p. 14](#) chapter for instructions.

Fan coil function: allows the fan coil ventilation speed to be set between Car, Night, Minimum and Maximum.

Ventilation speed: allows you to set the ventilation speed of the conditioners between Automatic, Minimum, Average and Maximum.

Flap movement: If active, the flap of the device moves continuously, if deactivated, the flap remains fixed.

Night wellness: allows you to activate the Night function by limiting the ventilation speed to a very low value. The set temperature is automatically changed: in Heating mode it is decreased by -1 °C after one hour from activation and - 1

°C after two hours, in Cooling mode it is increased by + 1 °C after one hour from activation and + 1 °C after two hours.

Schedule: allows you to create a new calendar, select an existing calendar or edit the current calendar.

Programming offset: allows you to set a variation from - 3 °C to + 3 °C from the preset temperature in the calendar.

Device name: allows the name of the device to be changed.

Allow function manual: If activated, this enables manual operation and the setting of different commands for individual appliances. By activating this function, it will be possible to operate the selected appliance manually, i.e. to set commands independently of the selected calendar or schedule.

Device keyboard: if activated it allows the use of the keys on the device display, if deactivated it blocks the use of the keys on the device display and allows management via App only.

Move device: allows you to move the device from one room to another within the same home.

Delete device: Allows you to remove the device from the application. The device will still remain configured within the home network.

6.3 Temporary temperature change

To edit

- from the specific screen of the single appliance
- drag the temperature control button to the desired value

The manual operation setting screen appears.

- select how long you want to deactivate programming and activate manual operation
- in case of activation for X days or X hours select the number

Manual operation is activated and you return to the specific screen of the individual device.

An indication that the appliance is in manual operation appears.

TROUBLESHOOTING

7.1 Error signals

⚠ In case of errors, please follow the instructions in the App carefully.

⚠ If the alarm symbol appears:
 – select the symbol
 – displaying the error message

7.2 Troubleshooting

Effect	Cause	Solution
The application doesn't connect with the appliance	Problem with WiFi connection	Disconnect and reconnect to the appliance network
The appliance doesn't configure on IOS smartphone	IOS smartphones do not automatically find the WiFi network	Go to the phone's settings and select the appliance's WiFi network
It is not possible to identify the WiFi of the appliance	The WiFi transmitter may be switched off or the ppliance may already be configured	Check the presence of power to the appliance
It is not possible to configure several appliances inside a house	At the time of configuration two or more appliances are switched on	Configure a appliance at a time. Then switch one at a time on, keeping the others off, and start the configuration
MQTT Server Problem	The server is in maintenance	Wait

7.3 WiFi network On, Off and Reset

7.3.1 Controls EFA649 - EFB649 - EWF644 - EWF647

To activate the WiFi network

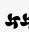
- from the display on, press the  key for about 10 seconds
The text "On" appearing on the display.
- do not touch any keys for another 10 seconds
The WiFi network is active and remains visible and usable with the last configured name.

To reset and restore the WiFi network to its original configuration

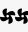
- from the display on, press the  key for about 10 seconds
The text "On" appearing on the display.
- press again the  key
The text "rSt" appearing on the display.
- do not touch any keys for another 10 seconds, switch off and on the power supply of the control.
WiFi network is reset.

To turn off the WiFi network

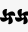
- from the display on, press the  key for about 10 seconds
The text "On" appearing on the display.
- press again the  key again until "OFF" appears
The text "OFF" appearing on the display.
- do not touch any keys for another 10 seconds
The WiFi network is turned off and will not be displayed on your smartphone or tablet.

⚠ After 30 seconds from the last action the control goes out and the settings is memorized.



7.3.2 Controls ECA031 - ECB031 and on-board display unit air conditioners

To change WiFi settings, it is necessary to access the special functions of the control.

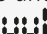
To access the setup menu

- from display off
- press and hold  for 10 seconds
The display lights up and the temperature appears.
- keep pressed until  appears

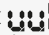
To change the WiFi settings

- select 
- press the icon 
- The settings are accessed.
- During editing, the symbol flashes to remind you that you are in the specific menu.
- Select "On" to enable WiFi
- Select " rSt" to reset the settings
- select OFF to disable WiFi
- confirm the change by pressing the  icon
By default, WiFi is set to On.

To exit the menu

- press the icon  for 10 seconds
- or wait 30 seconds the automatic shutdown
The temperature appears on the display.

 After 30 seconds from the last action the control goes out and the settings is memorized.



INNOVA S.r.l.
Via I Maggio 8 - 38089 Storo (TN) - ITALY
tel. +39.0465.670104 - fax +39.0465.674965
info@innovaenergie.com